

TOEPASSING SLEUTELWOORDEN

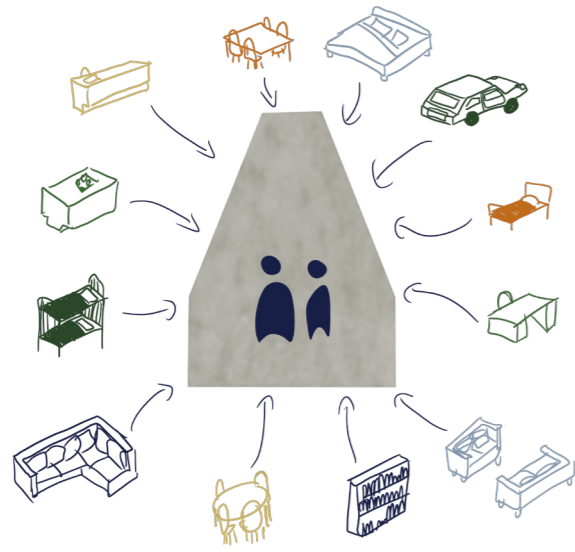

aanpasbaarheid

Vreewijkers kunnen hun woning naar wens indelen en aanpassen.



omgevingsgericht

Straatprofielen en achtergebieden die voortboorduren op de tuingedachte.

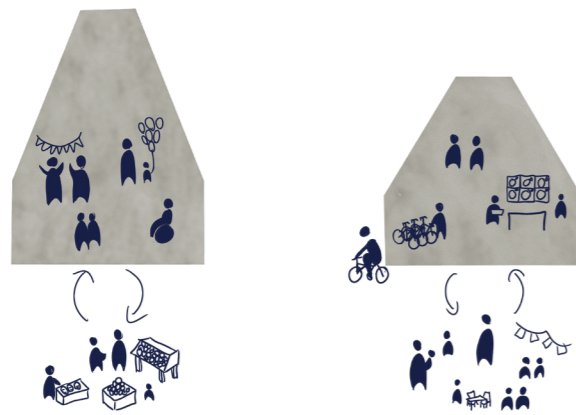

collectiviteit

Voorzieningen die door iedereen te gebruiken zijn, om de gehele wijk te verbinden.

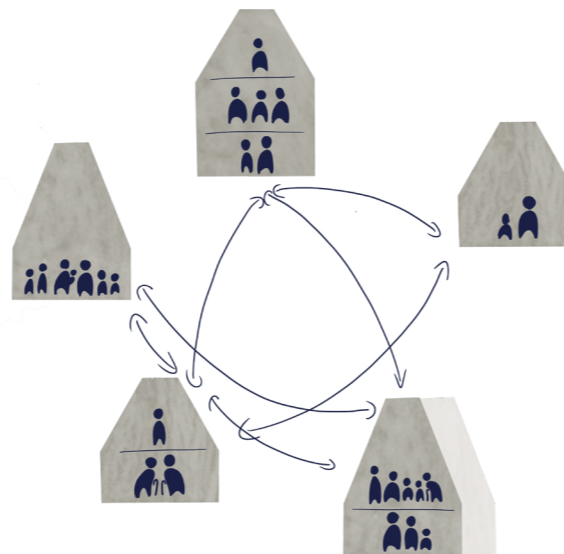

diversiteit

Door de grote diversiteit aan woningen kun je verhuizen in eigen buurt.

DOORSNEDE 1:100



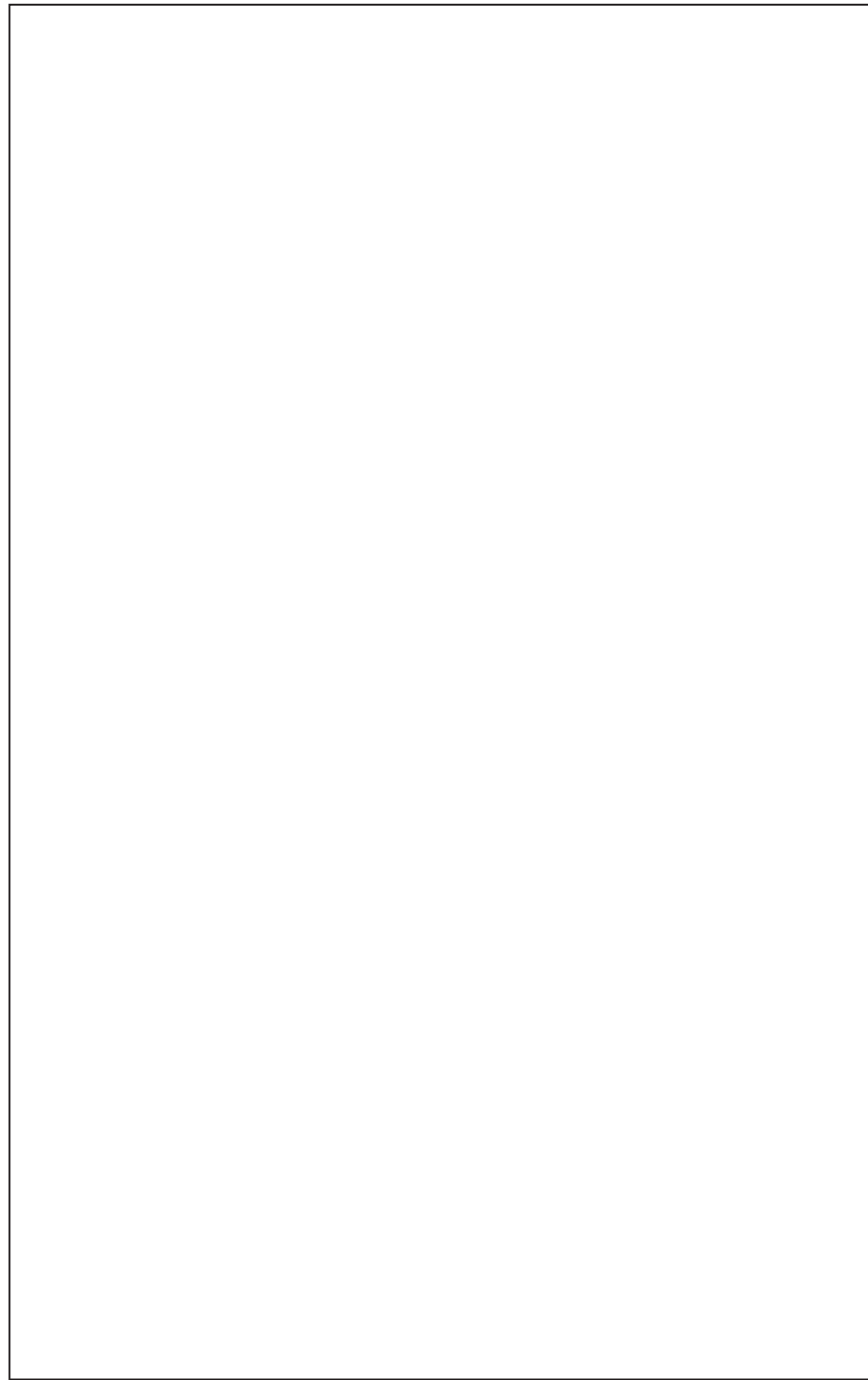

DOORSNEDE 1:100









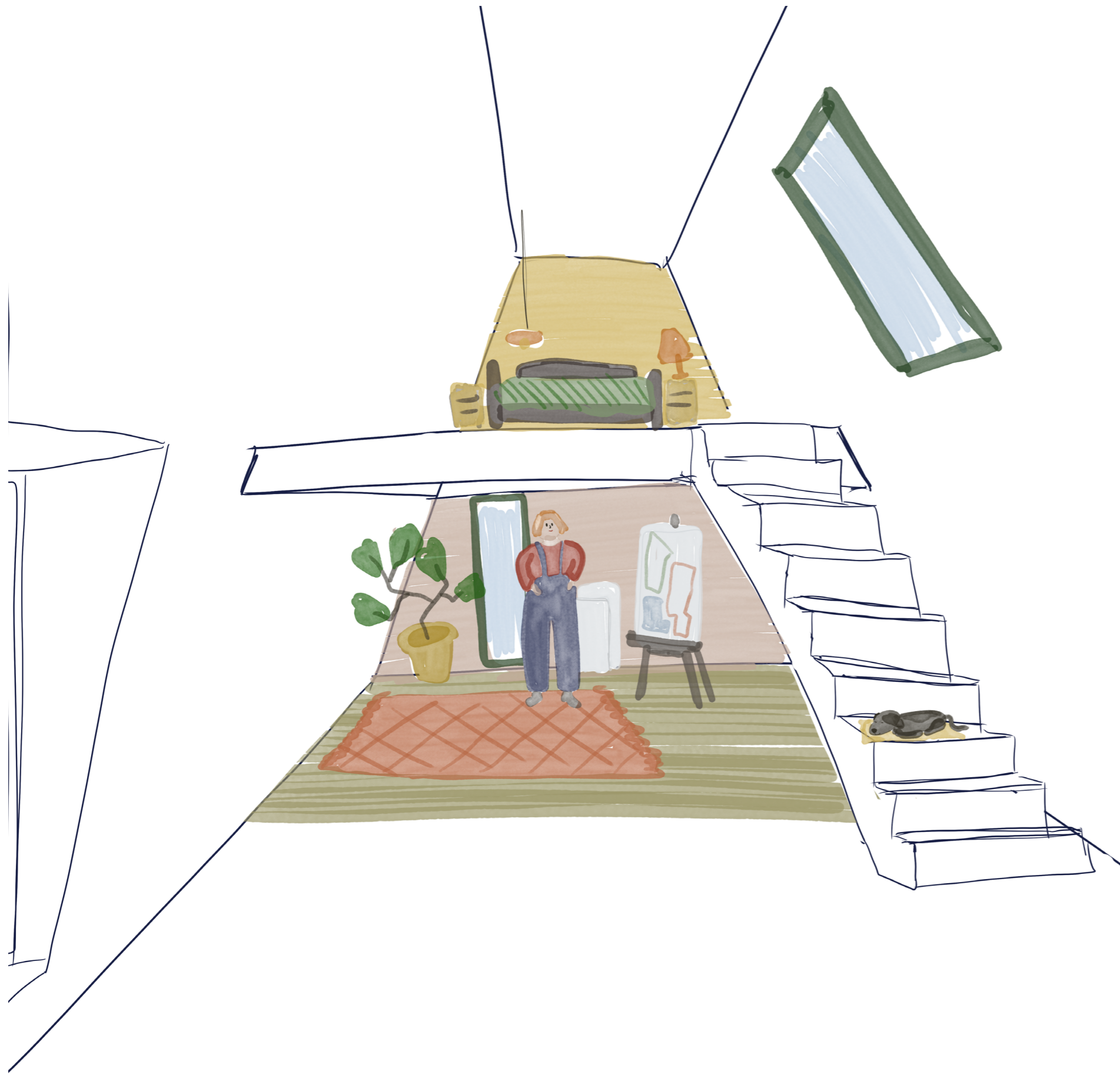



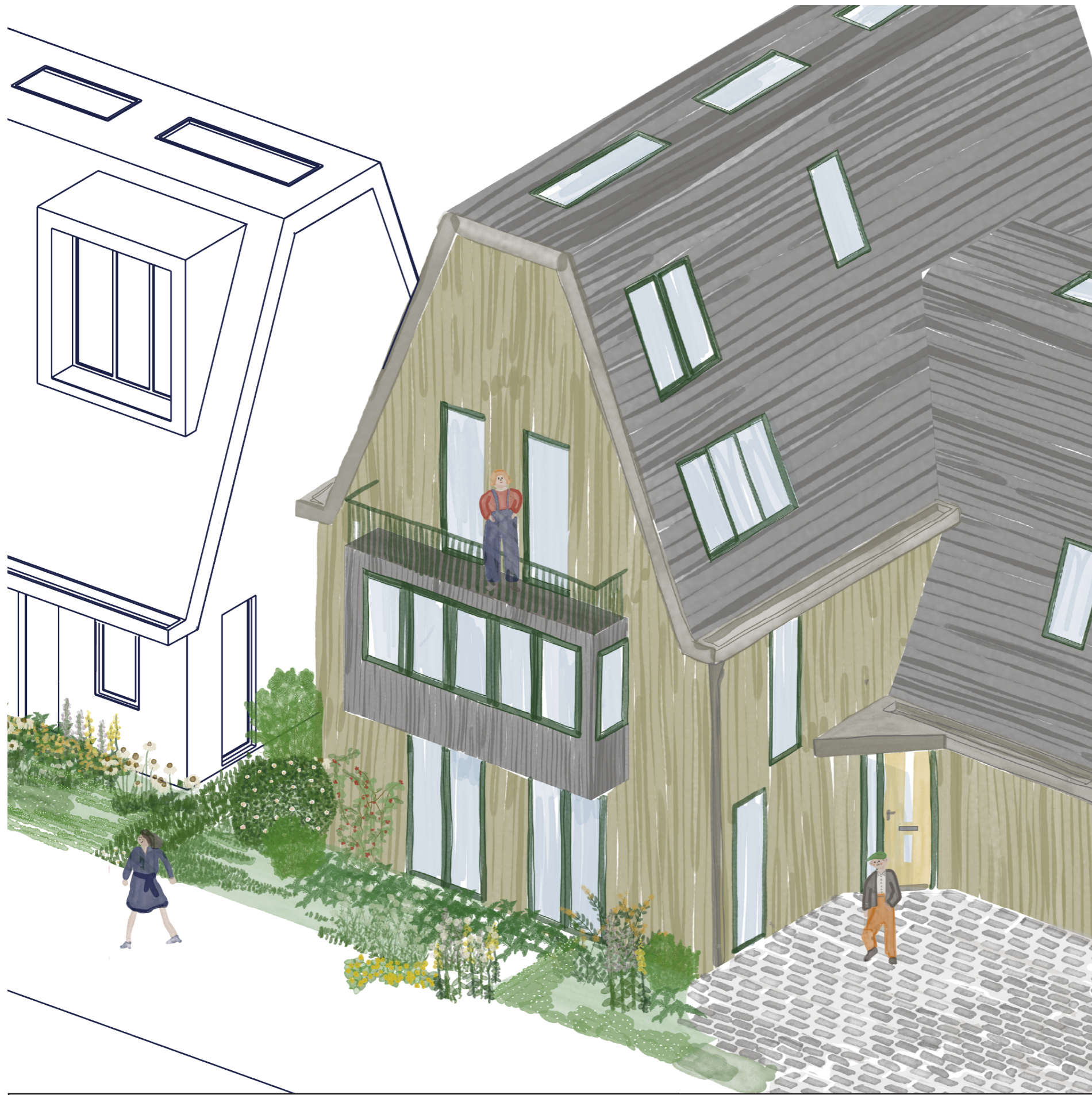



VOORZIENINGEN

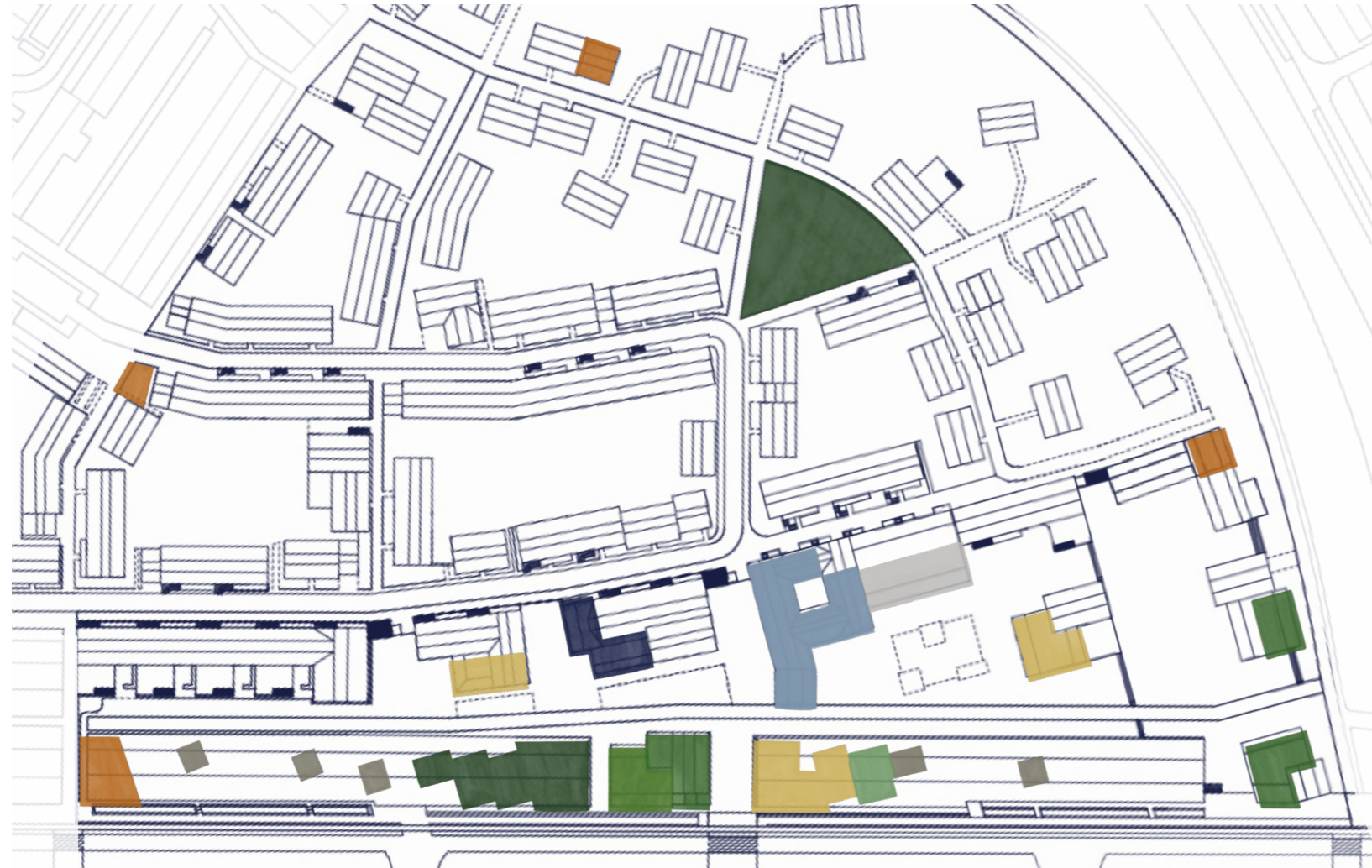

Commercieel:
supermarkt
winkels

Berging:
fietsenberging
afval punten

museum en zalen

kinderdagverblijf











Collectief:
wasruimte
pakketpunt
sportzaal
werkplaats
woonkamers
speeltuin

eetcafé

vrij indeelbaar, bijvoorbeeld:
huisarts
logeerkamers
kantoorruimte

WONINGTYPES



- | | | | | | |
|---|-------------------|---|--------------------------|---|------------------|
|  | straatwoning |  | kangeroewoning |  | parkwoning |
|  | straatappartement |  | woning met garage |  | park appartement |
|  | portiekwoning |  | studenten/starter woning |  | terraswoning |
|  | xl woning |  | atelier woning | | |