

Loven Diffusing Borders



Location in context

Loven is in an industrial area in the eastern part of Tilburg. It has a diversity of functions that are mostly focused on light to medium industry and is characterised by big box shaped volumes. Besides that there is something unique in the core of the neighbourhood; an old lint with residential houses and quite a close inhabitants group. These two features show a **contrast spatially and socially**.

Where these two characteristics collide exists a space that is unused, unseen and hidden; the **Crossover space**. It has a great potential to transform into something more meaningful for the neighbourhood and district on a bigger scale. It can offer catalysts to develop the neighbourhood from inside out. Where the permeability can be improved, more accessible public green spaces can be added, a gradient can be applied from residential to industry and remove the hard border between worker and resident.

The crossover space can be a start to diffuse the border.



Messy building structure where small and big volumes collide Identifying crossover spaces Crossover spaces as catalysts for development New spaces and routing create destinations within the old structure

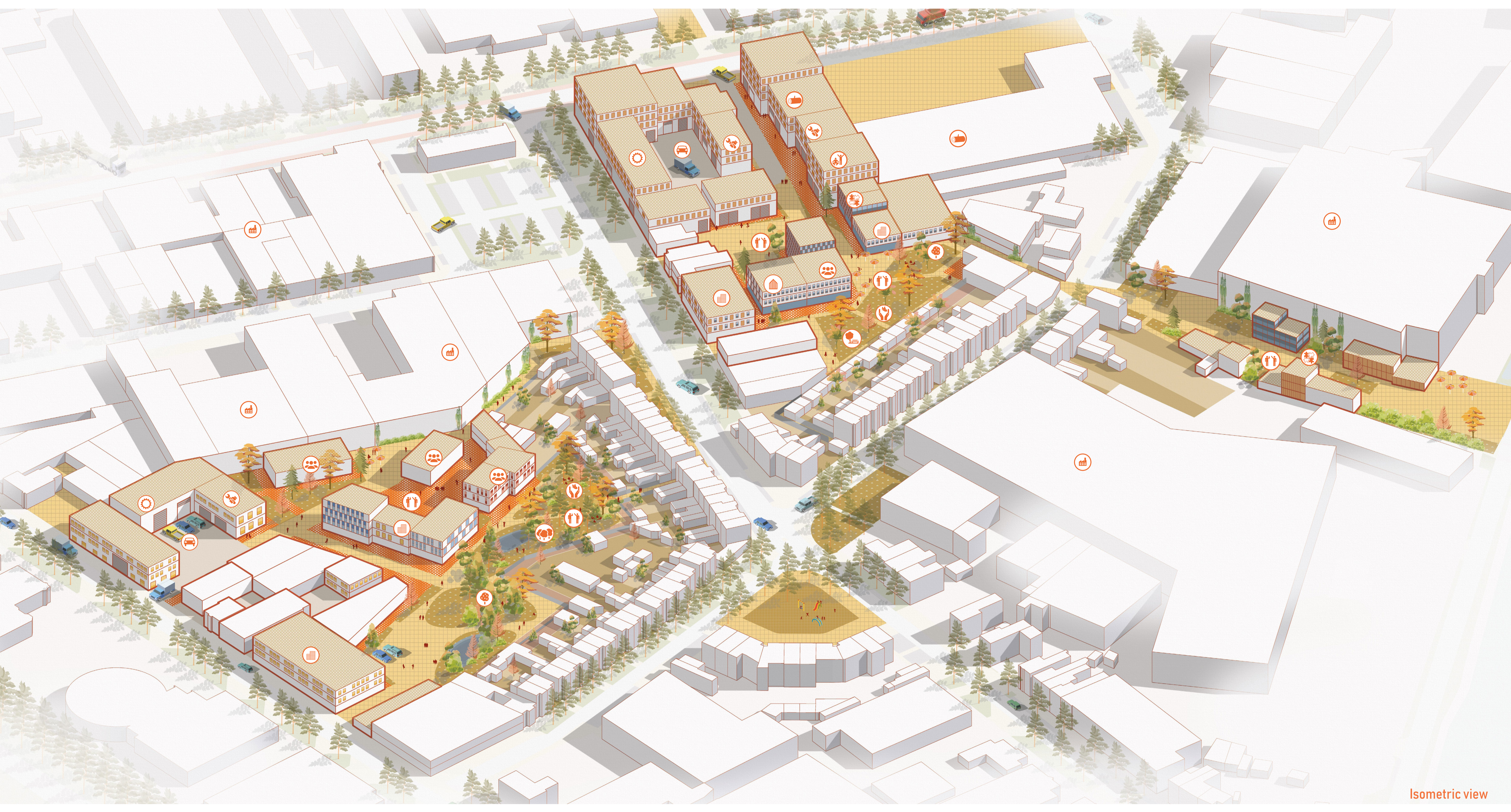

Isometric view



Collage Starters space



Collage Crossover space

Residential

Crossover space
- Tiny forrest -

Communal square

Workingstreet

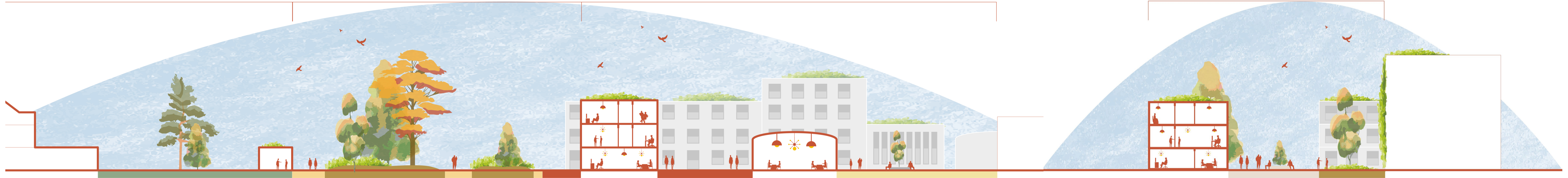

Section 1:250 - A - A'

Section 1:250 - B - B'



The crossover park

The crossover park is the first intervention using the crossover spaces as a new commons in the neighbourhood. It provides an interaction space between the light industry and the residential area. The interaction takes place socially as well as spatially.

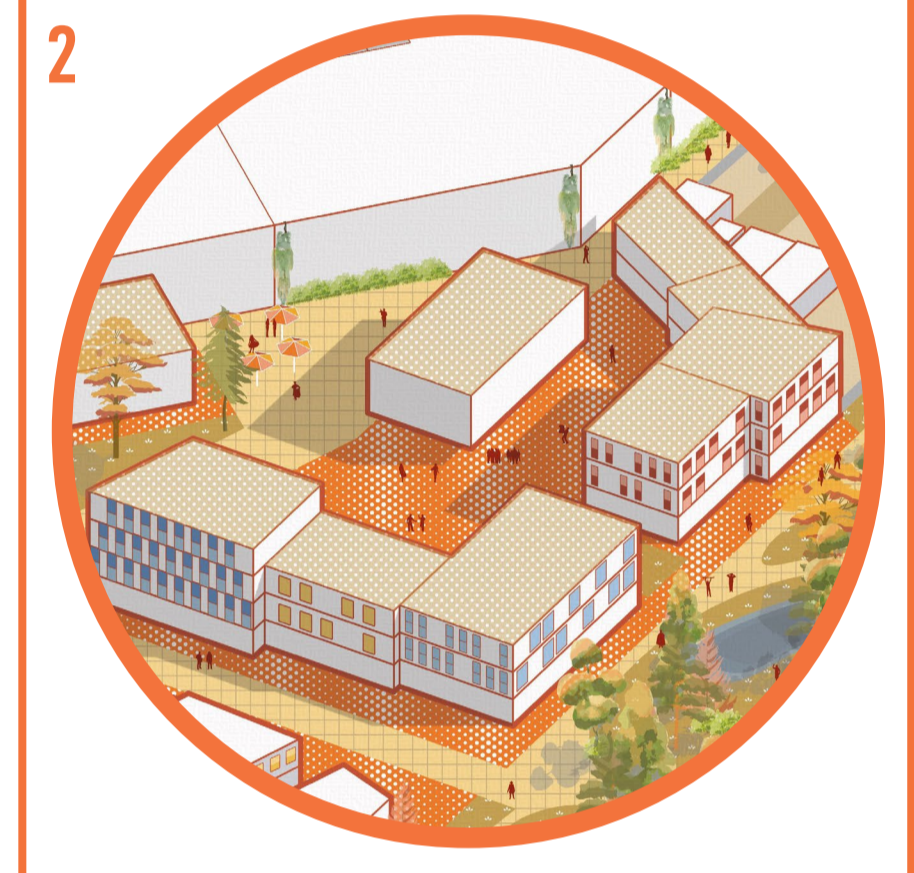

Neighborhood/Community center

This is an intervention that gradually comes after the crossover park. It provides the neighbourhood with a public space and building that functions as a community center. It provides in studios, ateliers, a neighbourhood kitchen and workspaces. It's a commons not only for the neighbourhood but also for people and communities outside. The building doesn't have to be fixed and can also be in a form of a pavilion for example.

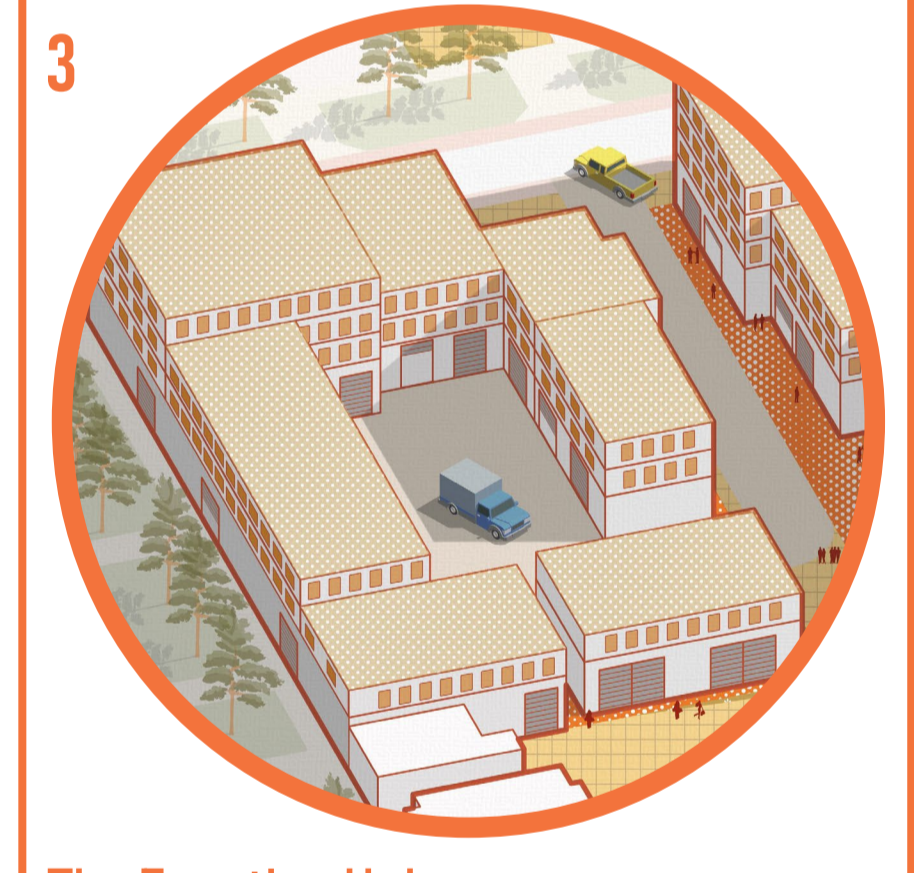

The Function Hub

The function hub is a place that provides alternative spaces for the existing business-owners and companies. In case of removing buildings the owners can relocate. Besides that these hubs can provide workspaces in the time that they aren't occupied by the businesses to lively places spread over a longer period of time.

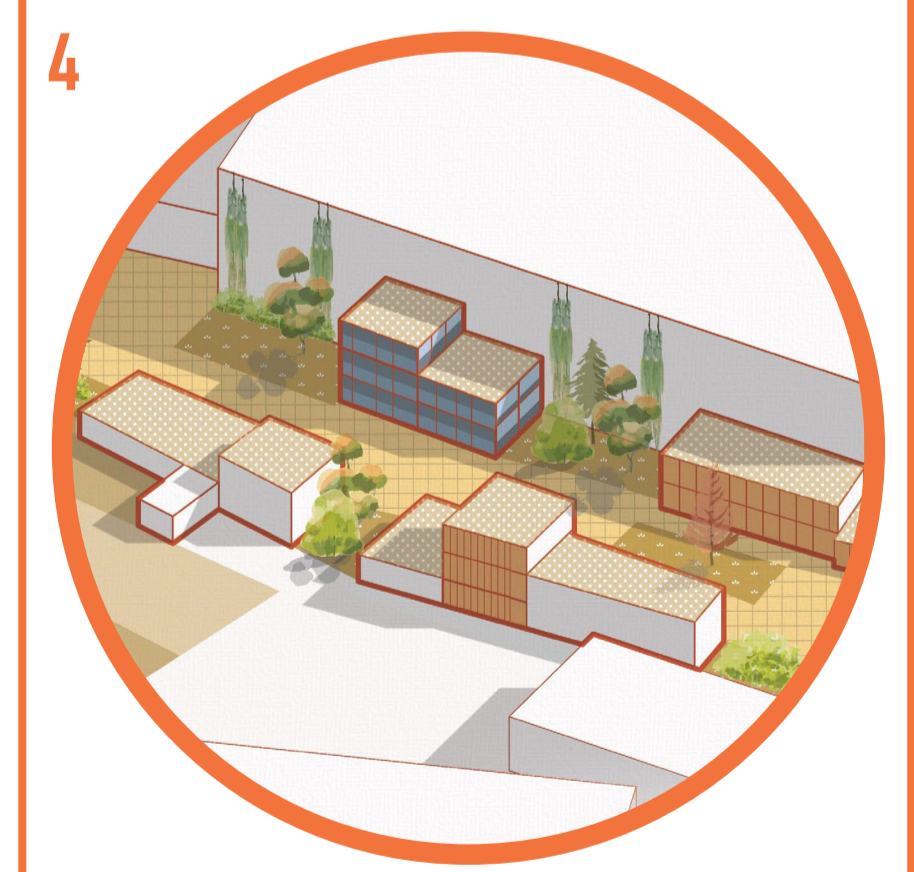

The Entrance

This is the starting connection from the canal and it's the connection that eventually leads to the innery. Besides that it provides smaller studios and ateliers that can be rented out by starters and smaller companies to exchange knowledge within these circles but also provide working spaces in a lively part that's easily accessible from the innery. The public space is a space where these starters can meet and network, relax and interact in general.



Residential

Crossover Green

Neighborhood
workshops

Workingstreet

Garage hub

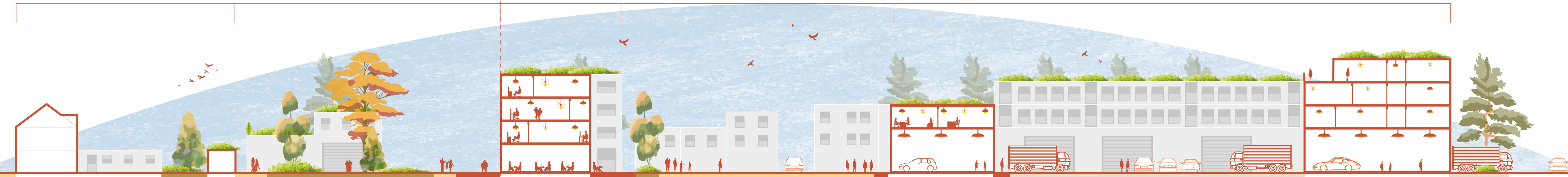

Section 1:250 - C - C'