

KATENDRECHT

At the south side of the Maas there is an old harbour, Katendrecht, the location for this Triangle school. It is divided in an old and a new part, the old part (red) is there since the harbours activities. The new part came after the harbours activities were relocated. The plot of the school is centered inbetween the old and the new part, to make an new urban statement.



TRIANGLE SCHOOL

The three phases of elementary school, represented by the shape of a triangle. The kindergarten is positioned in the left part of the triangle, this is the starting point of the school (red). From the age of four the children continue their journey in the bottom part of the triangle (green). When entering the upper classes the children move to the right part of the triangle (blue) to finish elementary school.

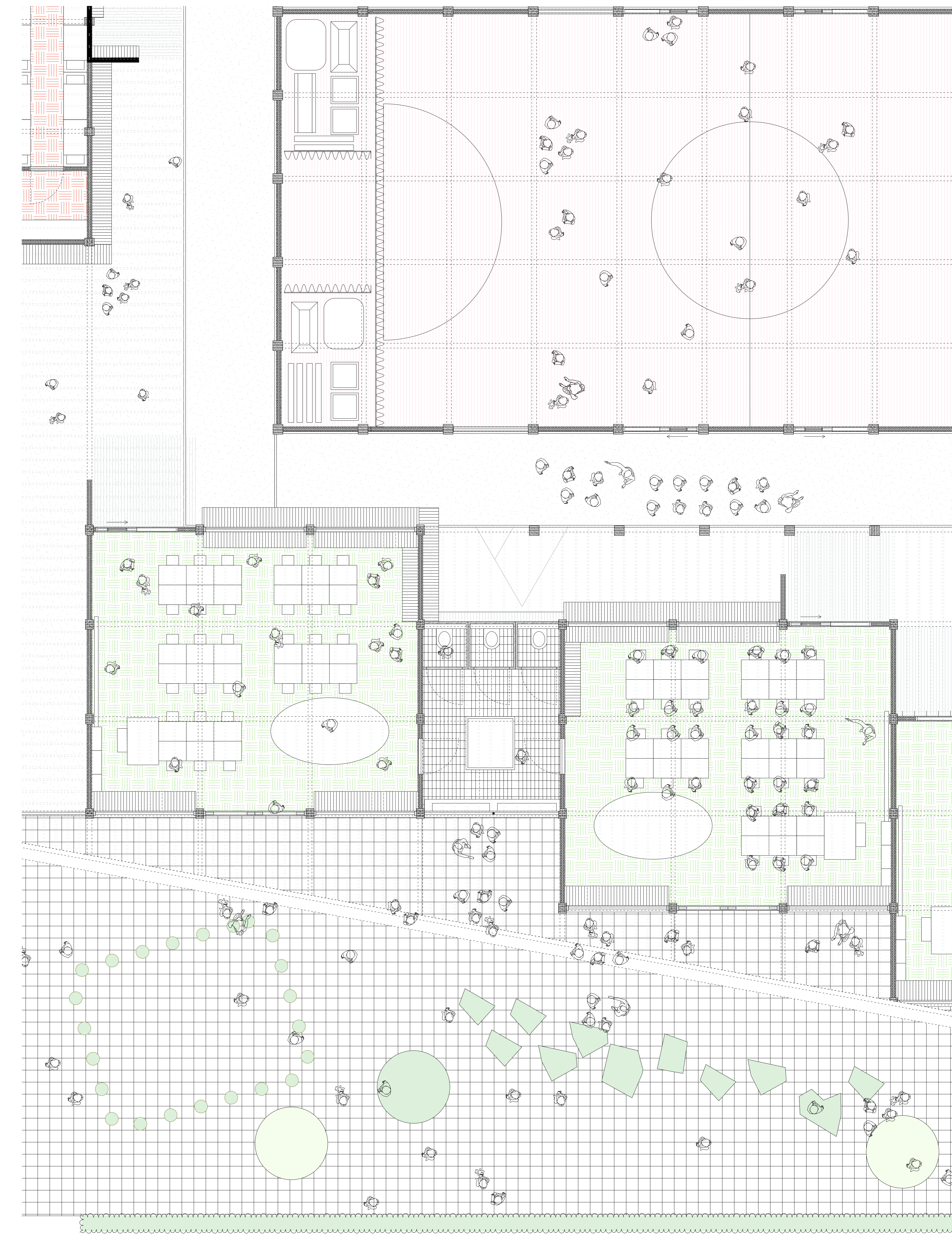

CLASSROOM

The cosy classrooms have three connections. The first connection is with the hallway, the wardrobe connects a sitting area on the hallway with a sitting area in the classroom. The second connection is with the lavatory which connects two classes. The third connection of the classroom is with the playing area. In order not to distract the children, they can only look outside when they're standing.

