

## situatie



ligging t.a.v openbaar vervoer



makers in m4h



ligging aan raamwerk m4h



missing links

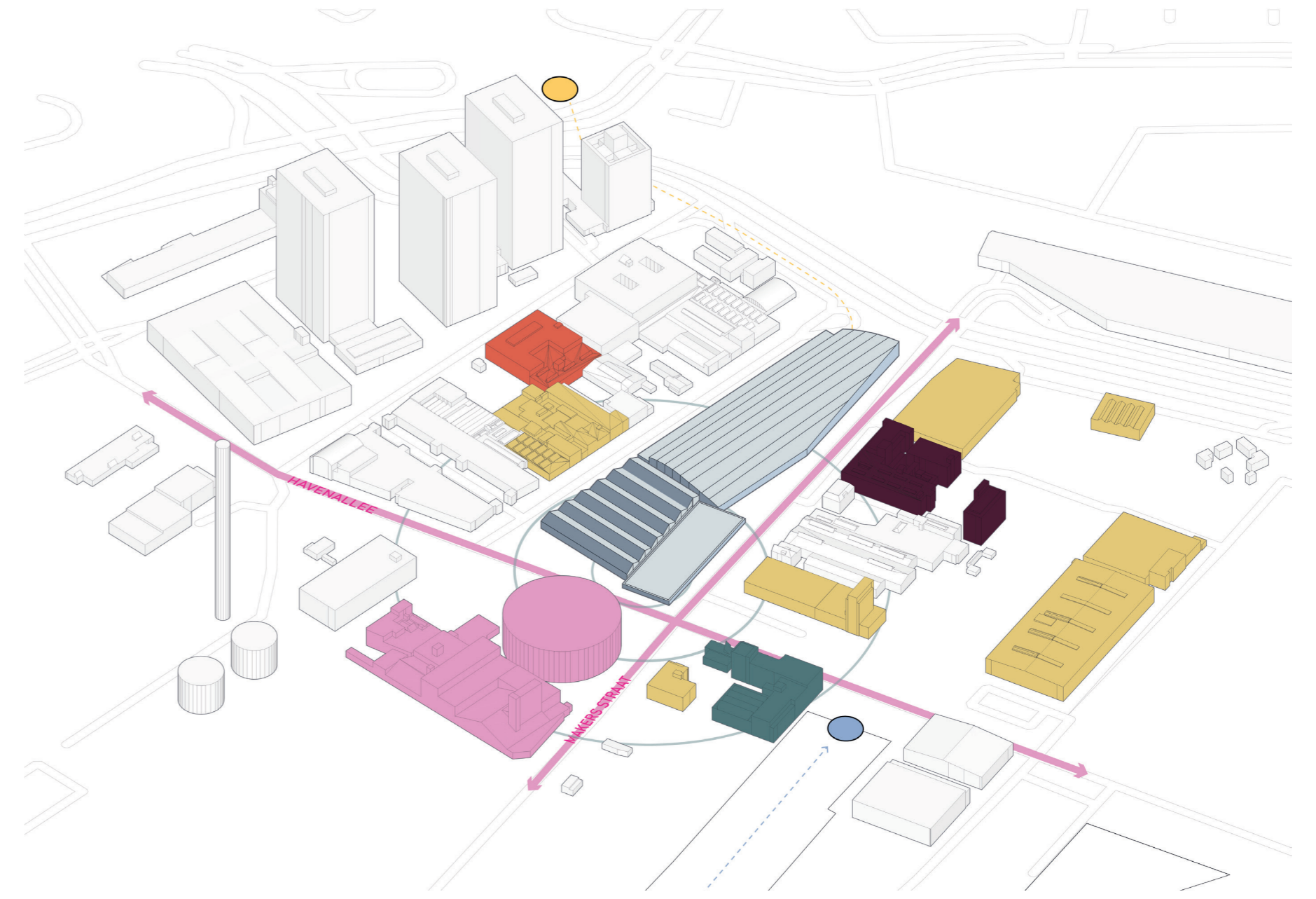

huidige situatie van het bouwblok t.a.v openbaar vervoer, makers in m4h & ligging aan het raamwerk

## knelpunten

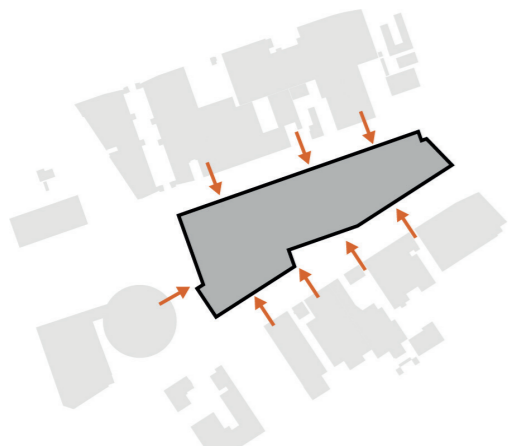

barriere

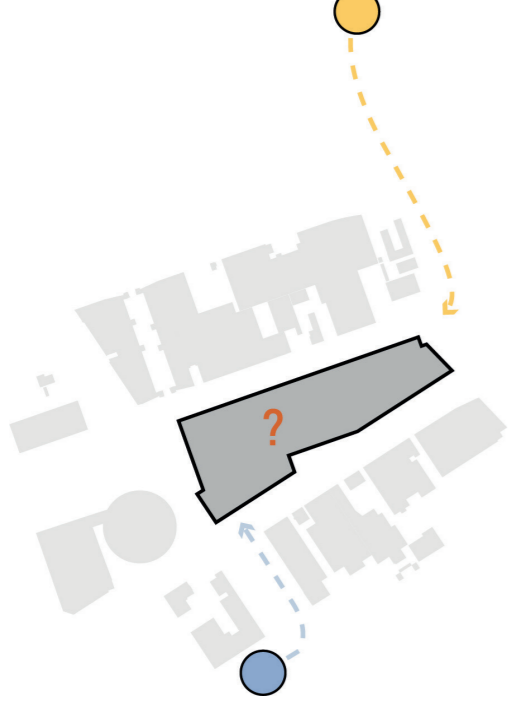

dicht blok

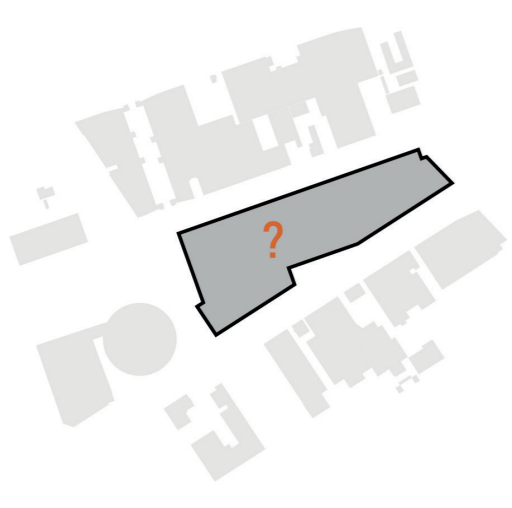

onbenutte positie

## kansen



doorwaarder geheel

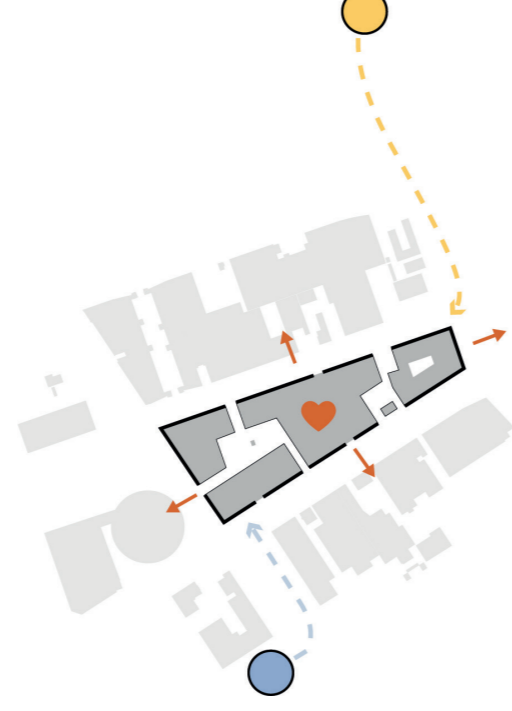

bestemming met alzijdige oriëntatie

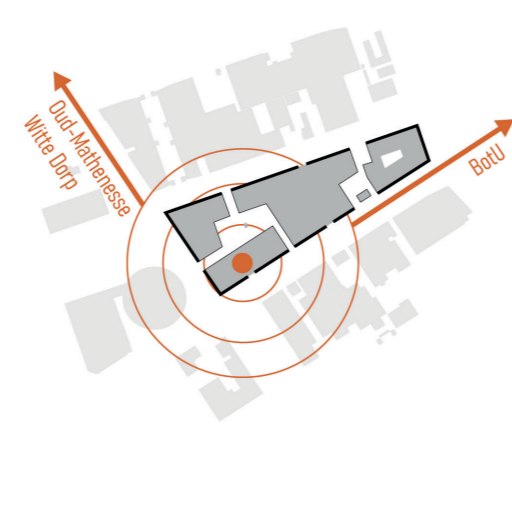

brandpunt tussen omliggende wijken en m4h



programmatische behoefte vanuit omliggende wijken

## CONCEPT

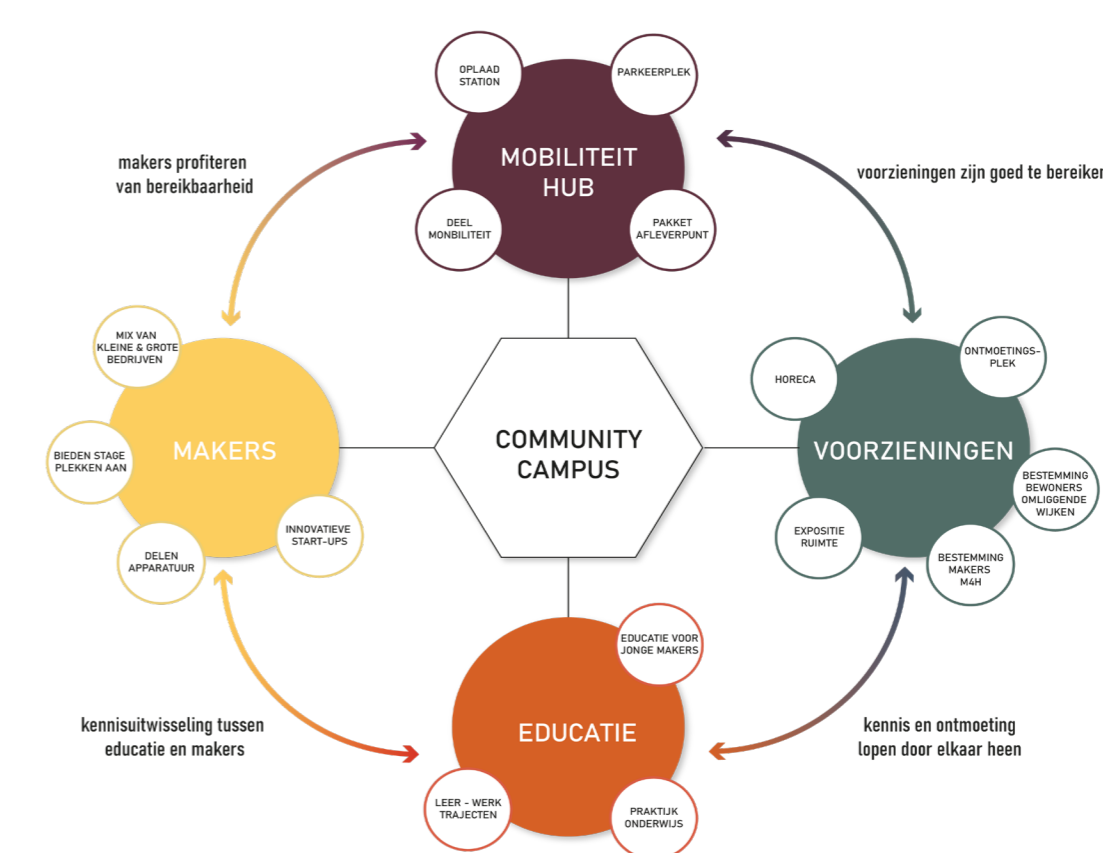

## morfologische bouwstenen

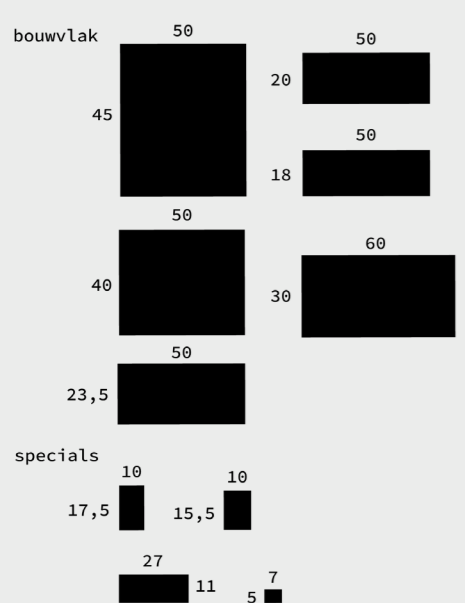

van helmont cluster

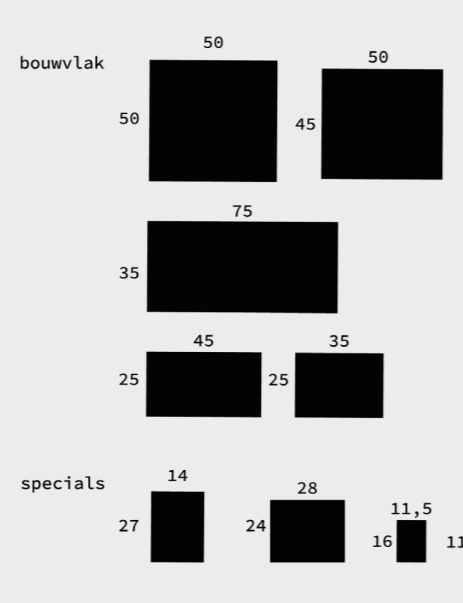

keile cluster

## architectuur

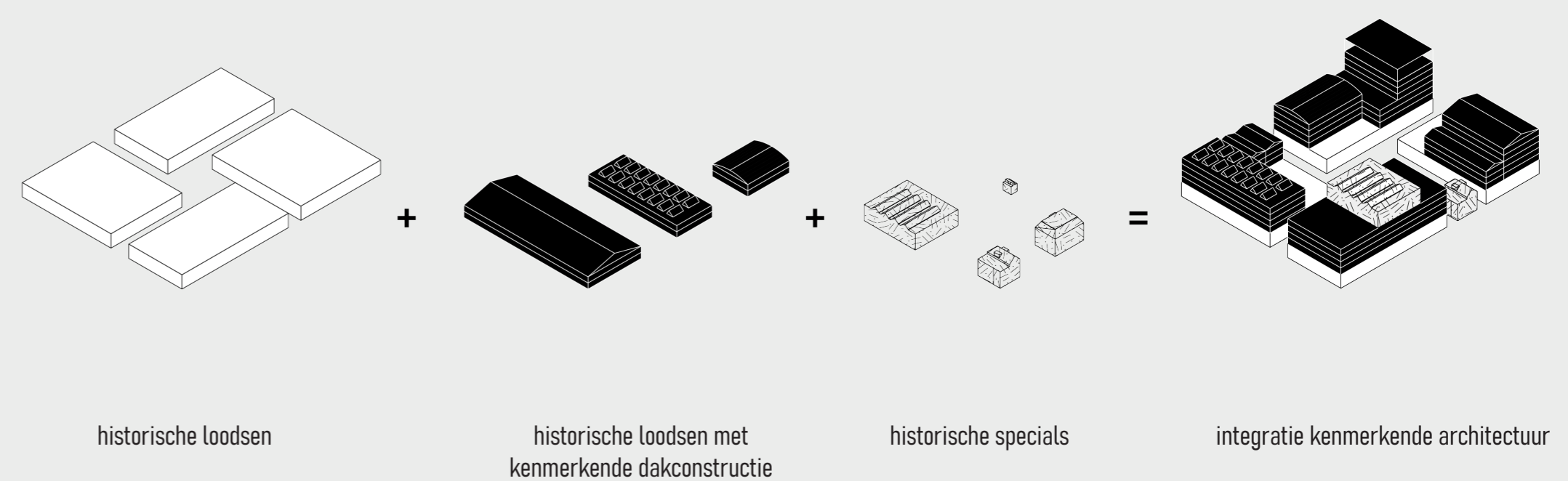



- COMMUNITY HUB**
  - co-creating collage
  - techniek & engineering
  - onderzoek center
  - innovatie huiskamer
- LEVEND ARCHIEF M4H**
  - material archief
  - toekomst 2.0
  - co-working spaces
  - expo ruimte
- MAAK BEDRIJVEN**
  - start-ups
  - software-ontwikkelaars
  - designers, engineers
  - kantoor ruimte
  - reparatie werkplaats / gereedschap atelier

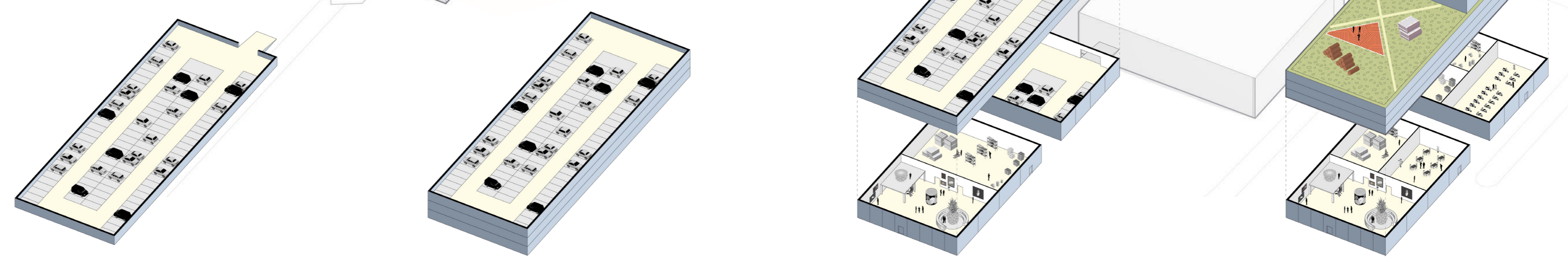

fasering levend archief m4h

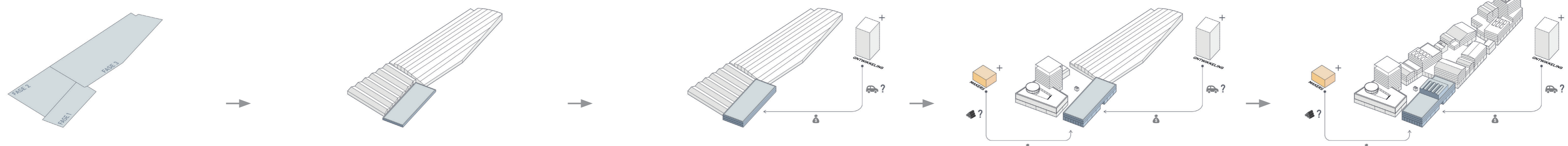

fasering (gemeente gronden, erfpacht)

bestaande situatie

fase 1

fase 2

fase 3

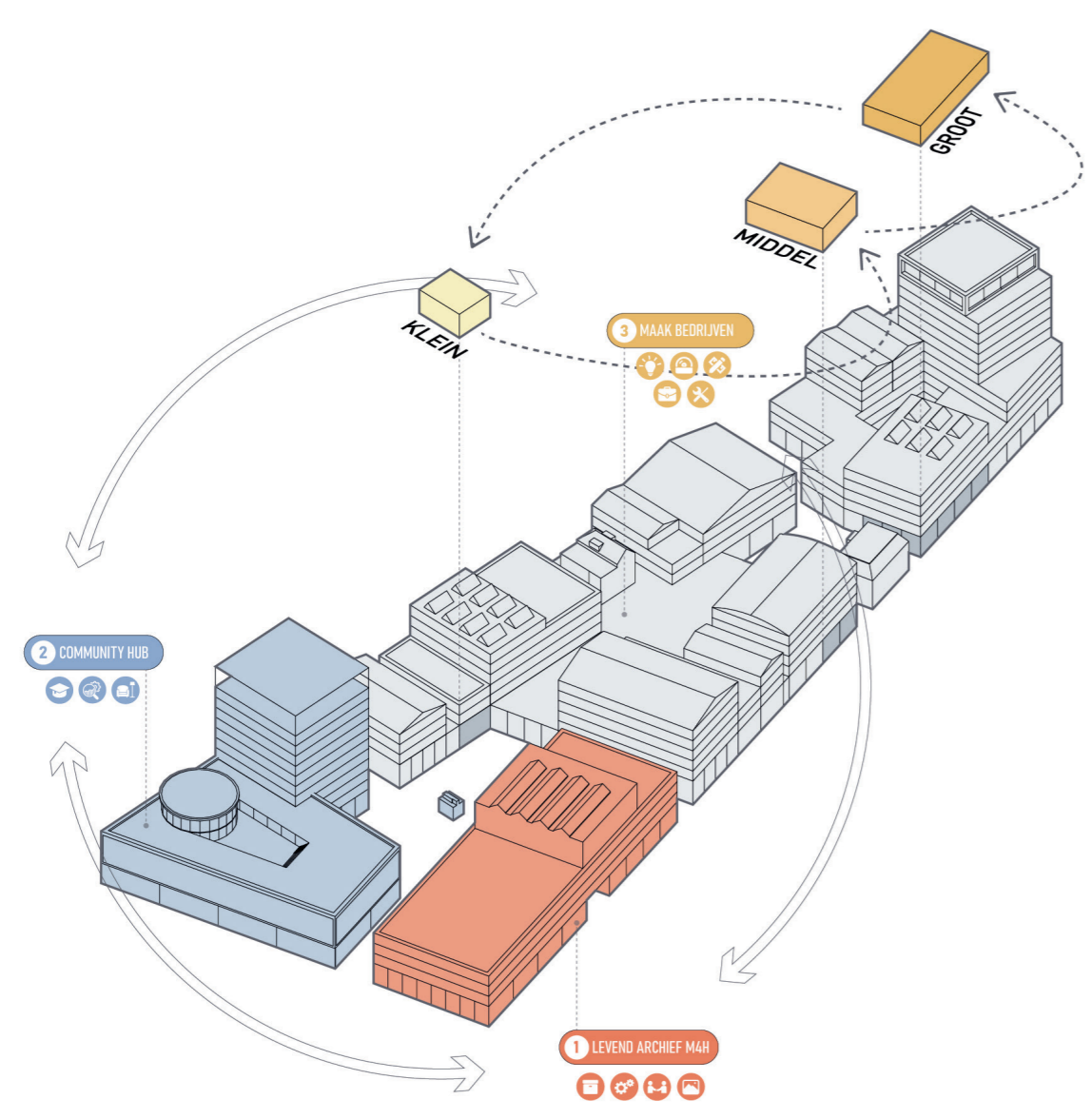

roadmap m4h

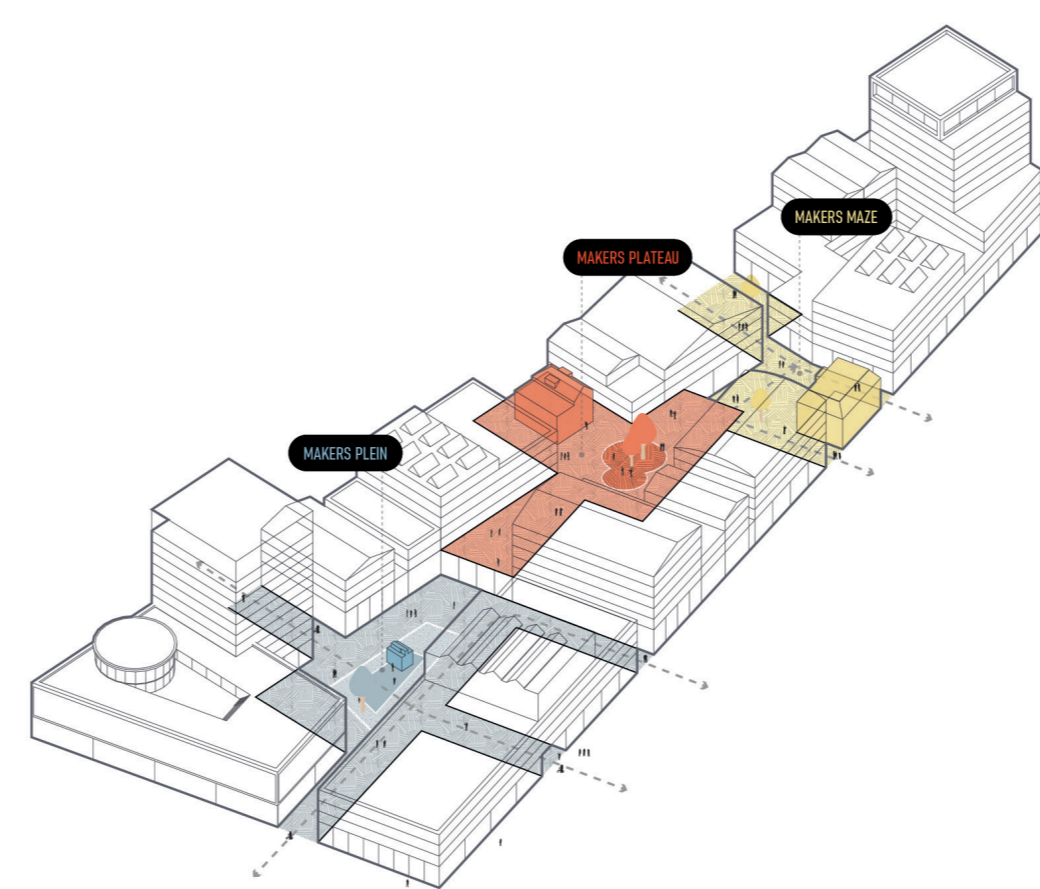

de pleinruimten

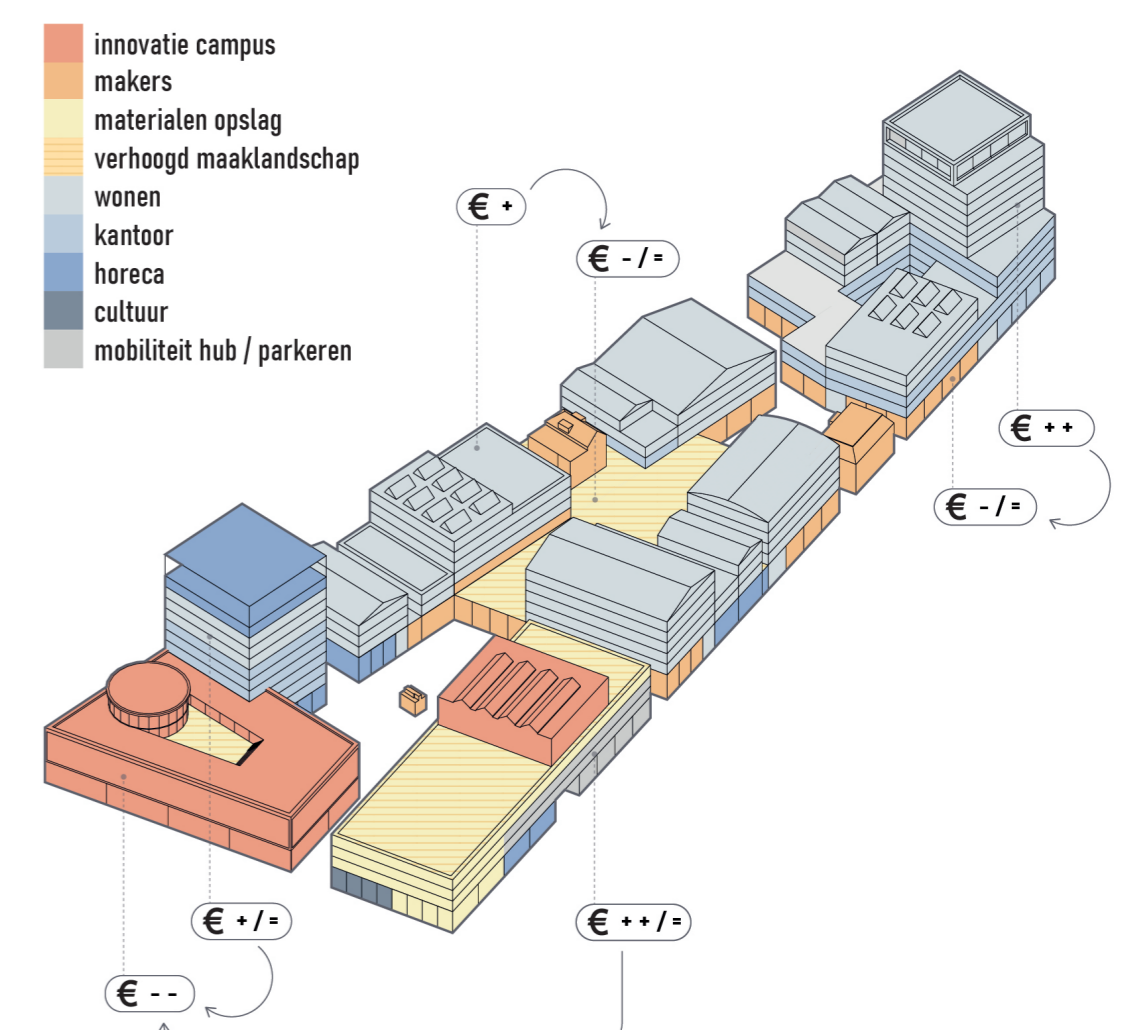

het programma + financieel model