

Refinding the balance

Willem Evers

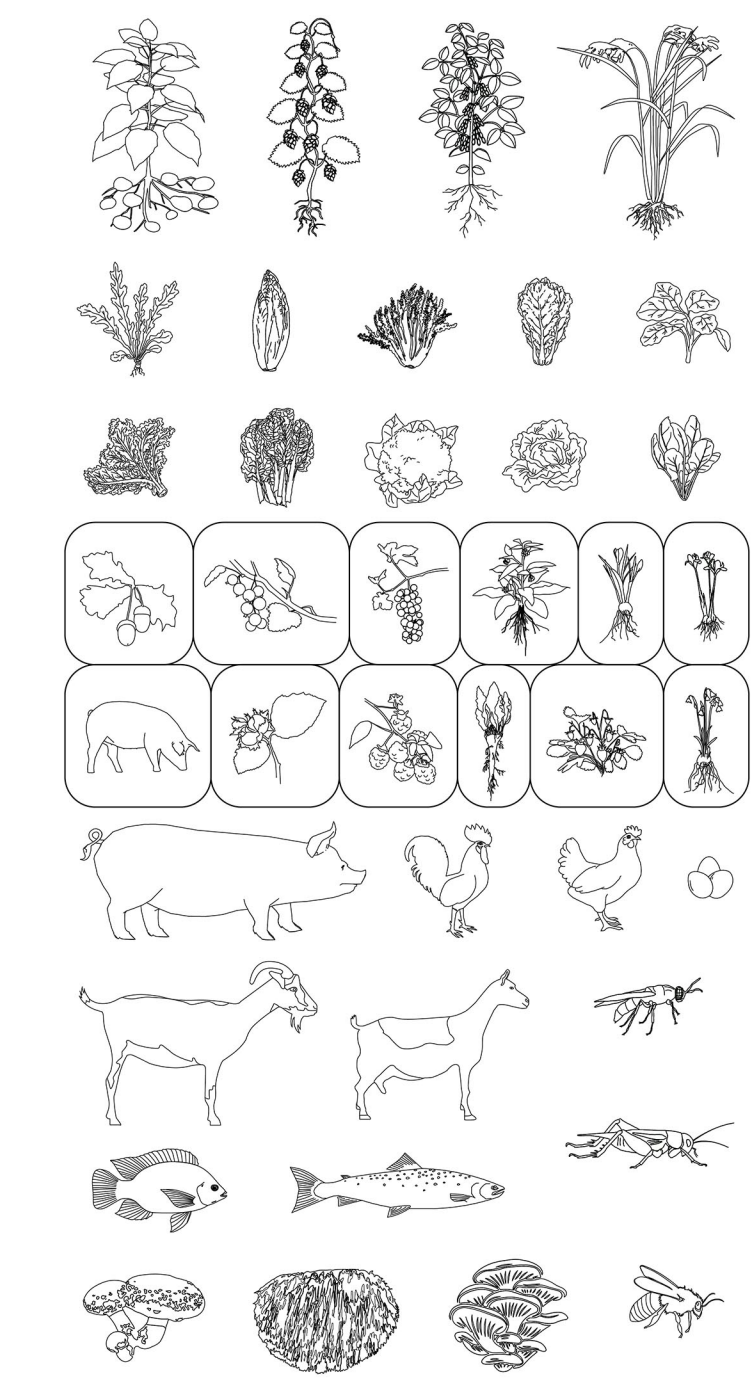

The Permaculture is a man-made, nature-inspired and balanced system. It is agriculture by learning from nature. A system in which farmers learn to cope with transitions like nature does, finding ways to balance itself and allowing for life, growth, bloom, yield and, in turn, death.

In this proposed urban farm, I have created a grid-based system in which a cooperating selection of plants, shrubs and trees is placed: a guild. A single guild works as an individually functioning mini-farm of different species. A combination of many varieties forms a super-farm. It creates an Eden where wilderness and production are in balance. A place where a farm can grow produce sustainably and without the typical brute force of regular agriculture, whilst developing its own balanced ecosystem. The natural succession and the combination of cooperating plants enrich the soil, stabilize the ecosystem and allow for a higher harvest.

The strength of the guilds will be exploited even further by engineered interventions, permaculture PLUS. These interventions can be subtle and lightweight, like a barrier that protects the produce from people passing by, creating shade or enhancing the productivity of the guild. These interventions are scattered both strategically in or around guilds or even randomly across the farm.

In a future where food is grown detached from nature, where people live in cities disconnected from the wilderness – this system of urban farming will contribute to the health of the city's dwellers. A place to pick your own produce, a place to get lost for a moment, a place to reconnect with nature. A place where urban life can be in balance with nature.

MENU

Layer	Latin name	English name	Dutch name	Height	Color	Root type	Soil	Water	Placement
1. Ash guild	Fraxinus excelsior	Ash	Espe	12-15m	Green	Taproot	Moist	Shade	Central
	Malva sylvestris	Malva	Malva	1-2m	Red	Fibrous	Moist	Shade	Perimeter
	Prunella domestica	Blackberry	Prunella	1-2m	Red	Fibrous	Moist	Shade	Perimeter
	Urtica dioica	Nettle	Netel	1-2m	Green	Fibrous	Moist	Shade	Perimeter
	Salix alba	Willow	Witwilg	1-2m	Green	Taproot	Moist	Shade	Perimeter
	Alnus glutinosa	Almond	Alnus	1-2m	Green	Taproot	Moist	Shade	Perimeter
	Malva sylvestris	Malva	Malva	1-2m	Red	Fibrous	Moist	Shade	Perimeter
	Prunella domestica	Blackberry	Prunella	1-2m	Red	Fibrous	Moist	Shade	Perimeter
	Urtica dioica	Nettle	Netel	1-2m	Green	Fibrous	Moist	Shade	Perimeter
	Salix alba	Willow	Witwilg	1-2m	Green	Taproot	Moist	Shade	Perimeter
	Alnus glutinosa	Almond	Alnus	1-2m	Green	Taproot	Moist	Shade	Perimeter
	Malva sylvestris	Malva	Malva	1-2m	Red	Fibrous	Moist	Shade	Perimeter
2. Bee guild	Apis mellifera	Honeybee	Bijen	0-1m	Black	-	-	-	Central
	Bombus terrestris	Common bumblebee	Wilde bijen	0-1m	Black	-	-	-	Central
	Bombus lucorum	Lucerne bumblebee	Wilde bijen	0-1m	Black	-	-	-	Central
	Bombus pratorum	Field bumblebee	Wilde bijen	0-1m	Black	-	-	-	Central
	Bombus agrorum	Woolf bumblebee	Wilde bijen	0-1m	Black	-	-	-	Central
	Bombus terrestris	Common bumblebee	Wilde bijen	0-1m	Black	-	-	-	Central
	Bombus lucorum	Lucerne bumblebee	Wilde bijen	0-1m	Black	-	-	-	Central
	Bombus pratorum	Field bumblebee	Wilde bijen	0-1m	Black	-	-	-	Central
	Bombus agrorum	Woolf bumblebee	Wilde bijen	0-1m	Black	-	-	-	Central
	Bombus terrestris	Common bumblebee	Wilde bijen	0-1m	Black	-	-	-	Central
	Bombus lucorum	Lucerne bumblebee	Wilde bijen	0-1m	Black	-	-	-	Central
	Bombus pratorum	Field bumblebee	Wilde bijen	0-1m	Black	-	-	-	Central
3. Pig guild	Sus scrofa	Pig	Varken	0-1m	Grey	-	-	-	Central
	Capra hircus	Goat	Geit	0-1m	White	-	-	-	Central
	Ovis montanus	Wild goat	Wildgeit	0-1m	White	-	-	-	Central
	Equus caballus	Horse	Paard	0-1m	White	-	-	-	Central
	Canis lupus	Wolf	Wolven	0-1m	Grey	-	-	-	Central
	Lepus timidus	Hare	Wilde eend	0-1m	White	-	-	-	Central
	Meleagris gallopavo	Turkey	Wilde eend	0-1m	White	-	-	-	Central
	Phasianus torquatus	Pheasant	Wilde eend	0-1m	White	-	-	-	Central
	Coturnix coturnix	Guinea fowl	Wilde eend	0-1m	White	-	-	-	Central
	Meleagris gallopavo	Turkey	Wilde eend	0-1m	White	-	-	-	Central
	Phasianus torquatus	Pheasant	Wilde eend	0-1m	White	-	-	-	Central
	Coturnix coturnix	Guinea fowl	Wilde eend	0-1m	White	-	-	-	Central

DATABASE

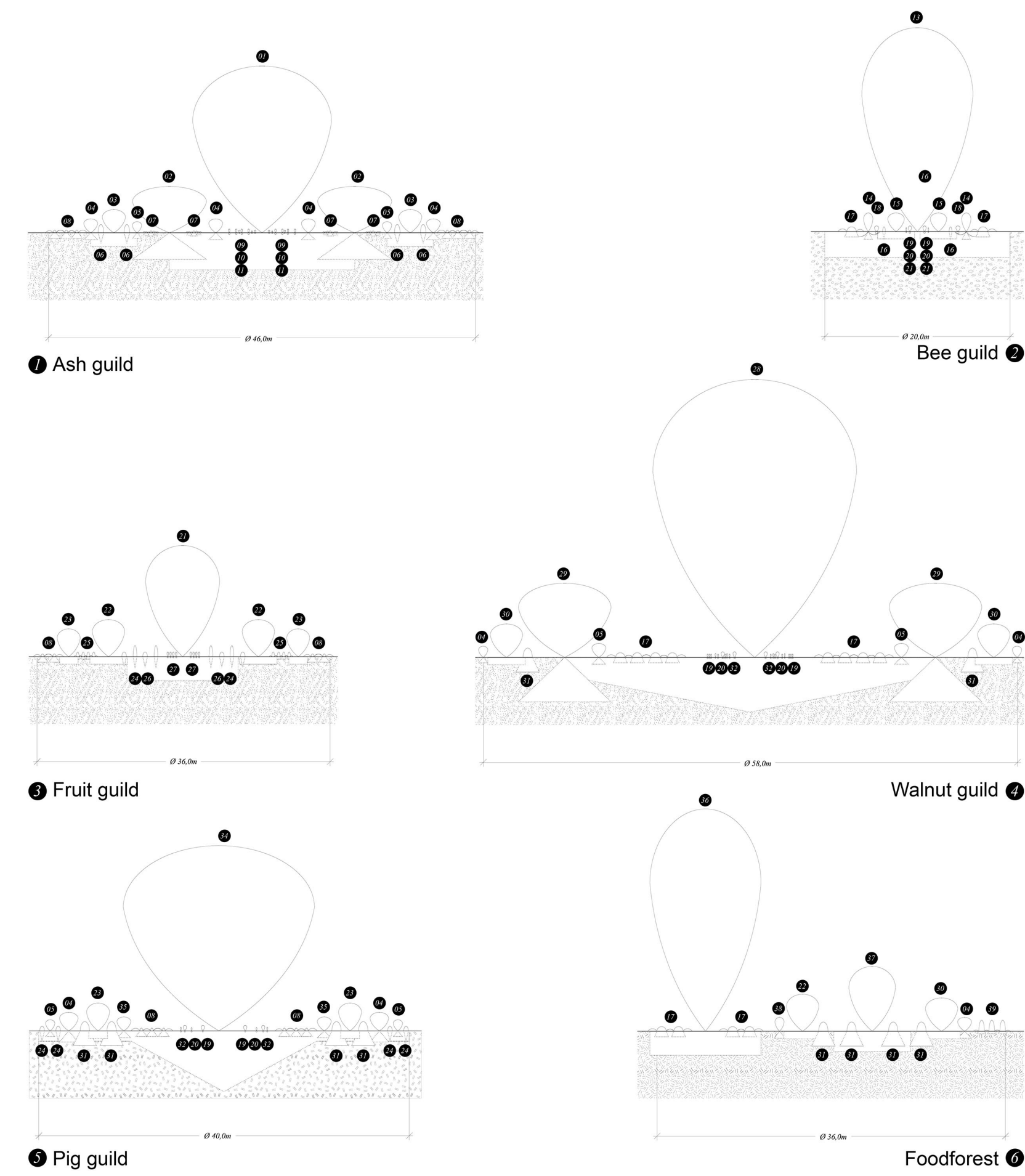

GUILDS

7. interventions

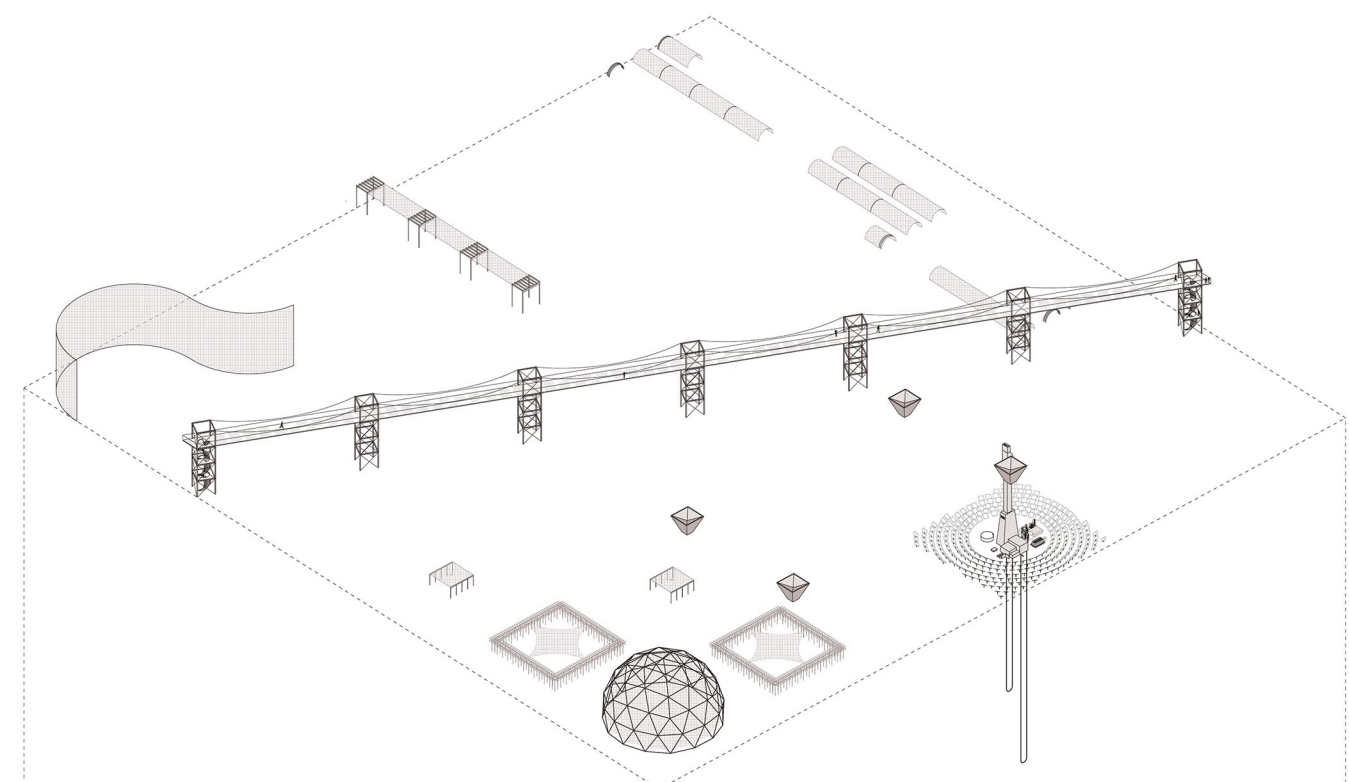

6. circulation

- asphalt
- paved
- unpaved

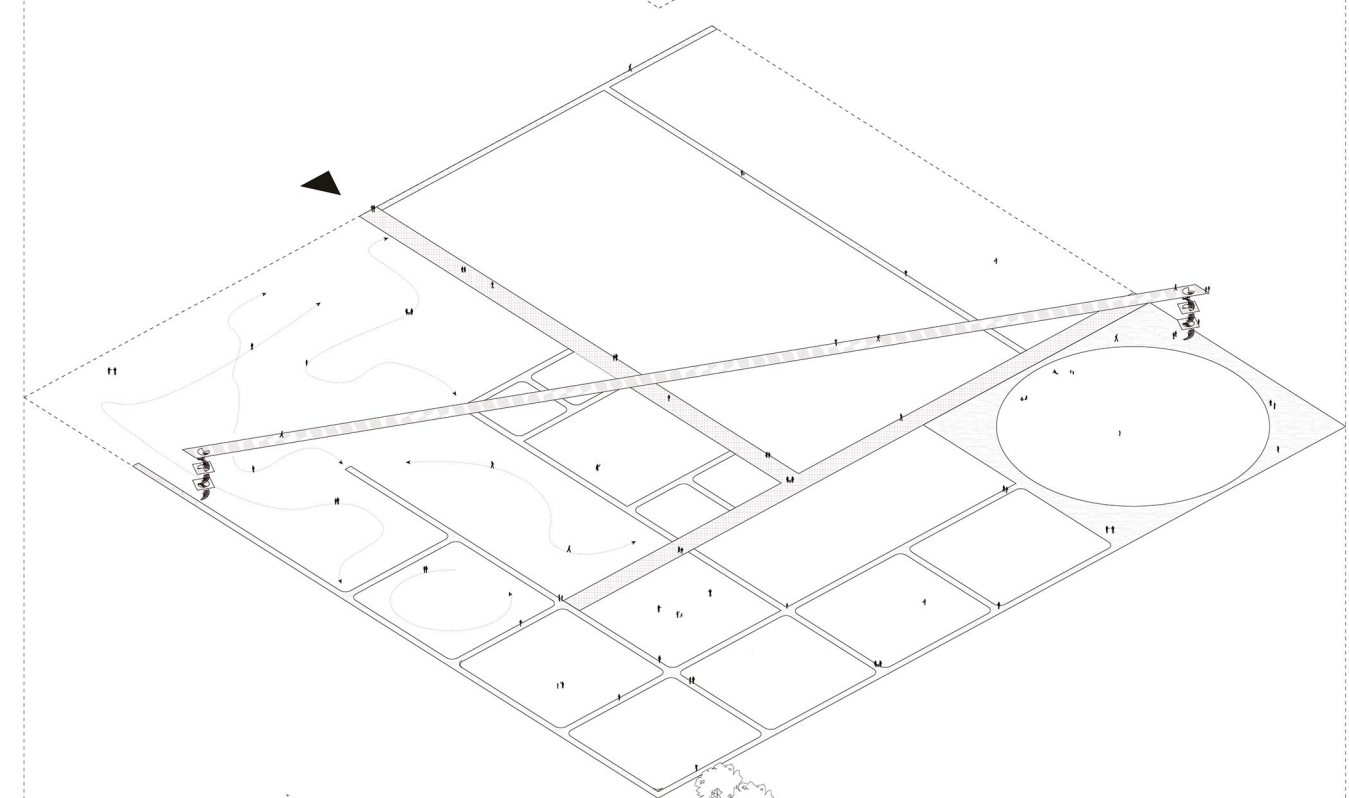

5. nature

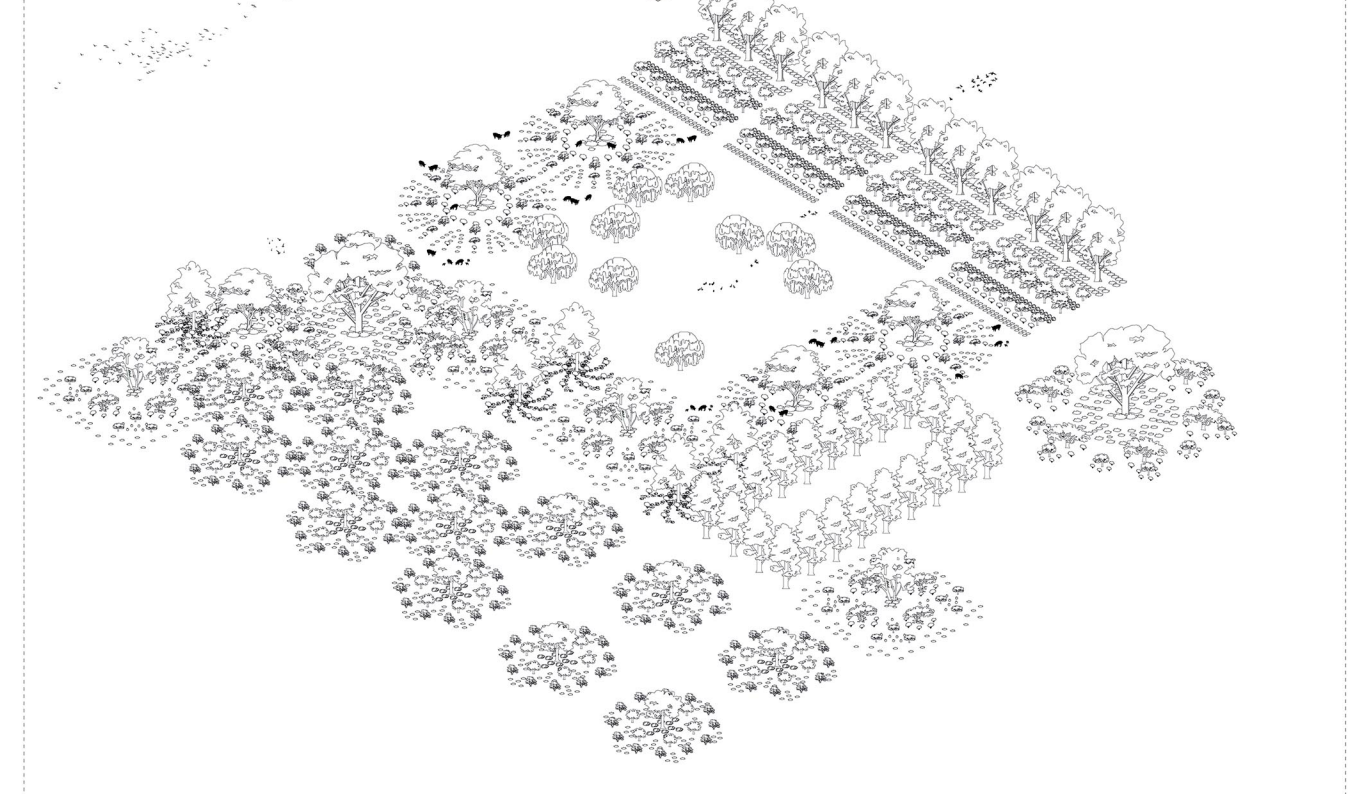

4. landscape

- soil
- water

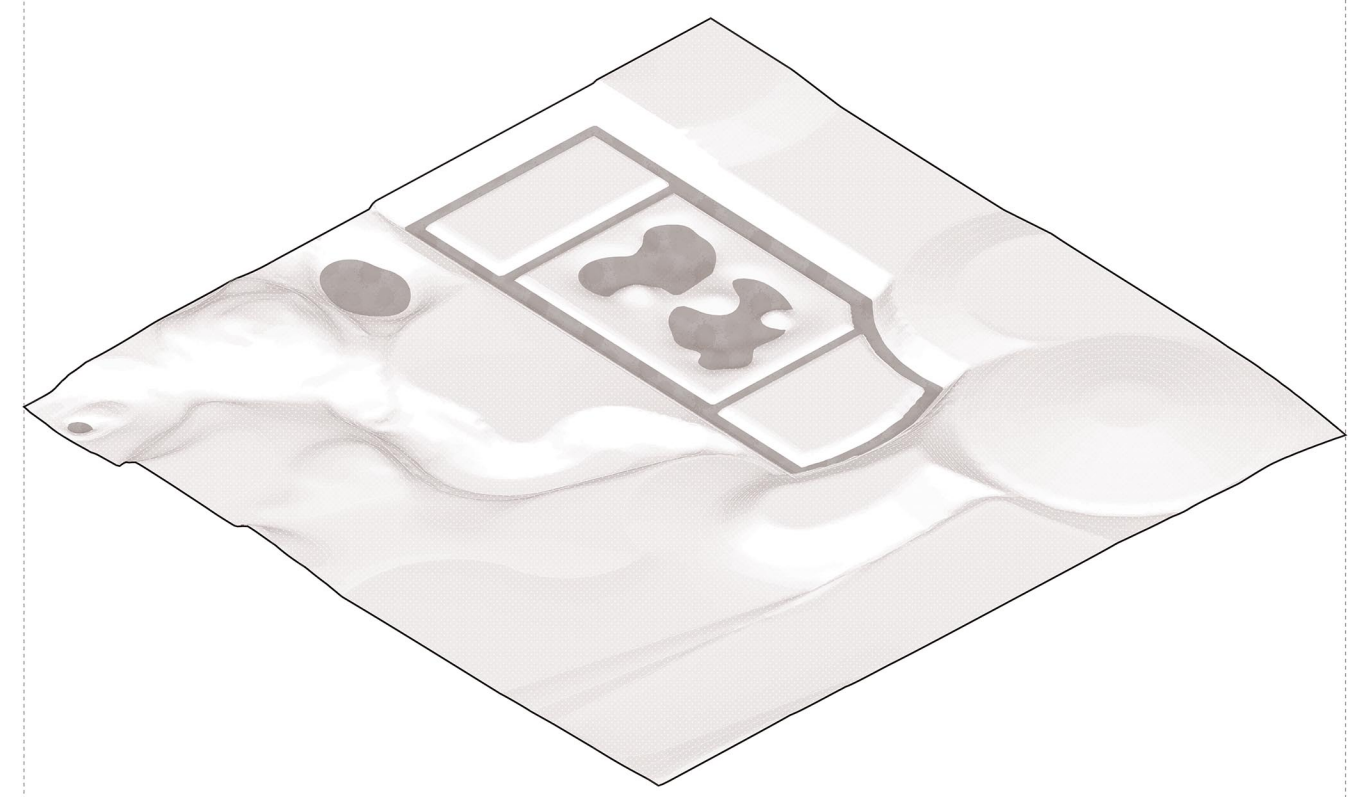

3. soil types + height differences

- ± 0 sand
- 2 loam
- 7 peat
- 11 clay
- wetlands

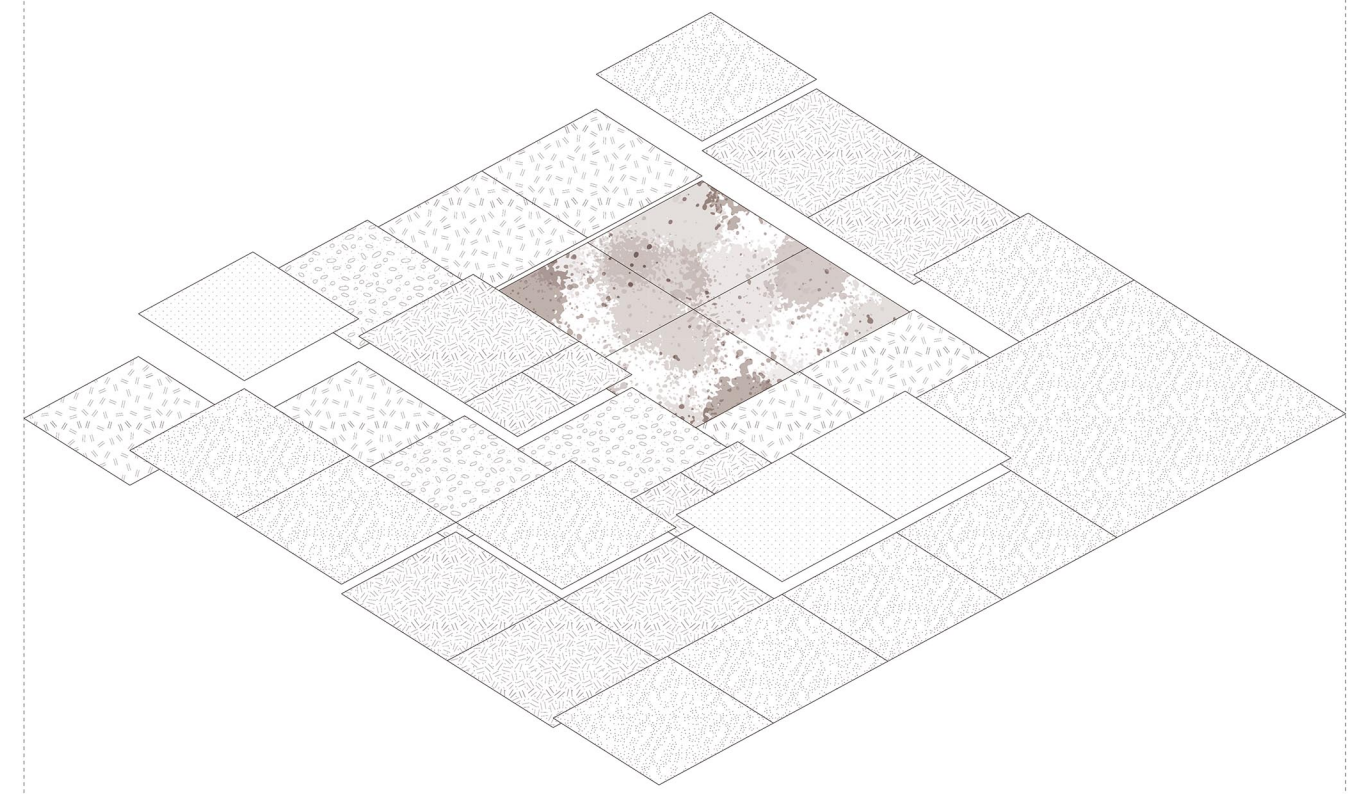

2. guilds

- ash guild
- fruitforest guild
- fruittree guilds
- pig guild
- pollinator guild
- support guild
- walnut guild
- wetland guild
- wilderness
- (mixed guilds)

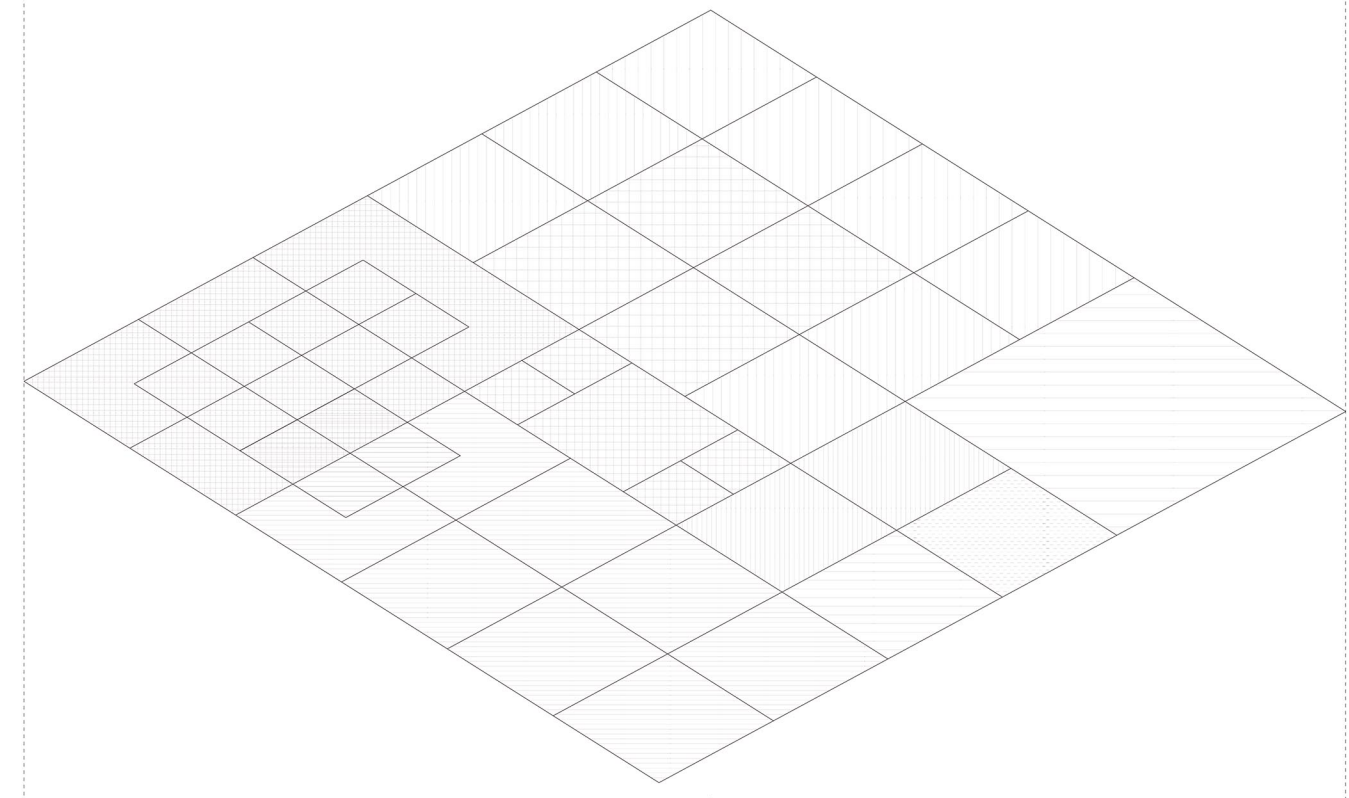

1. the grid + areas

- wilderness
- pig polder
- wetlands
- professional farm

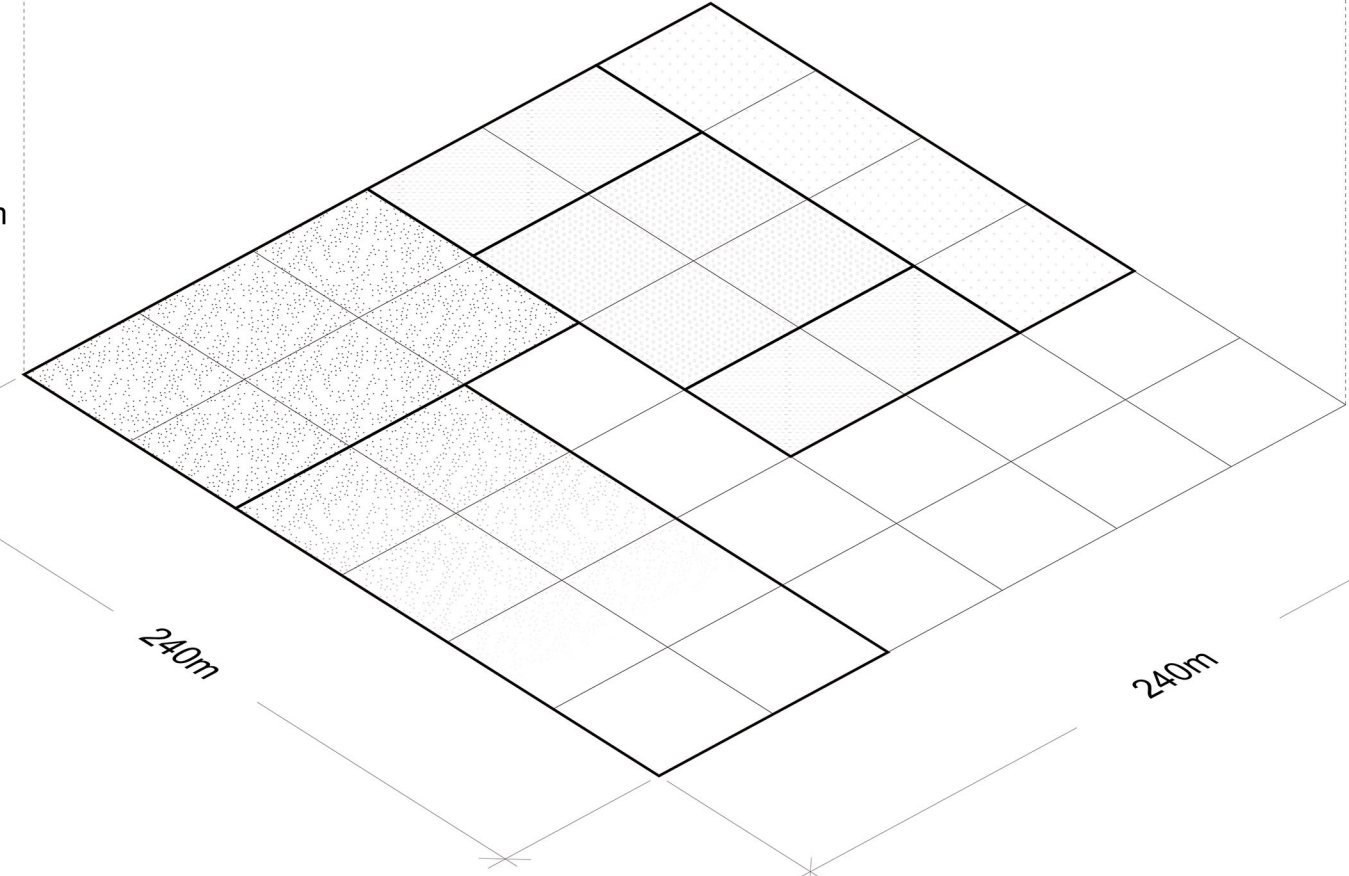

LAYERED DESIGN

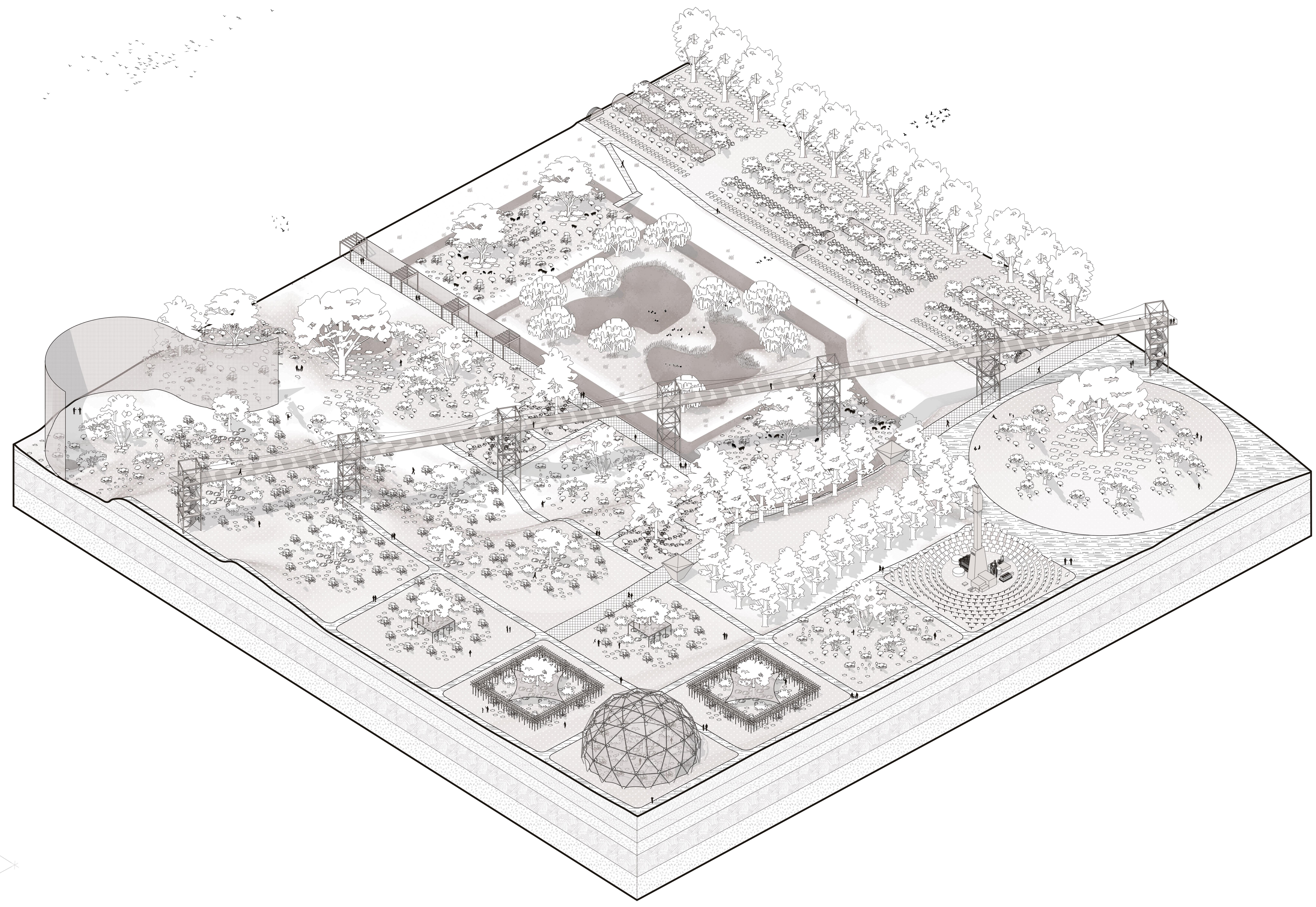

COMBINED DESIGN

Refinding the balance

Willem Evers

