

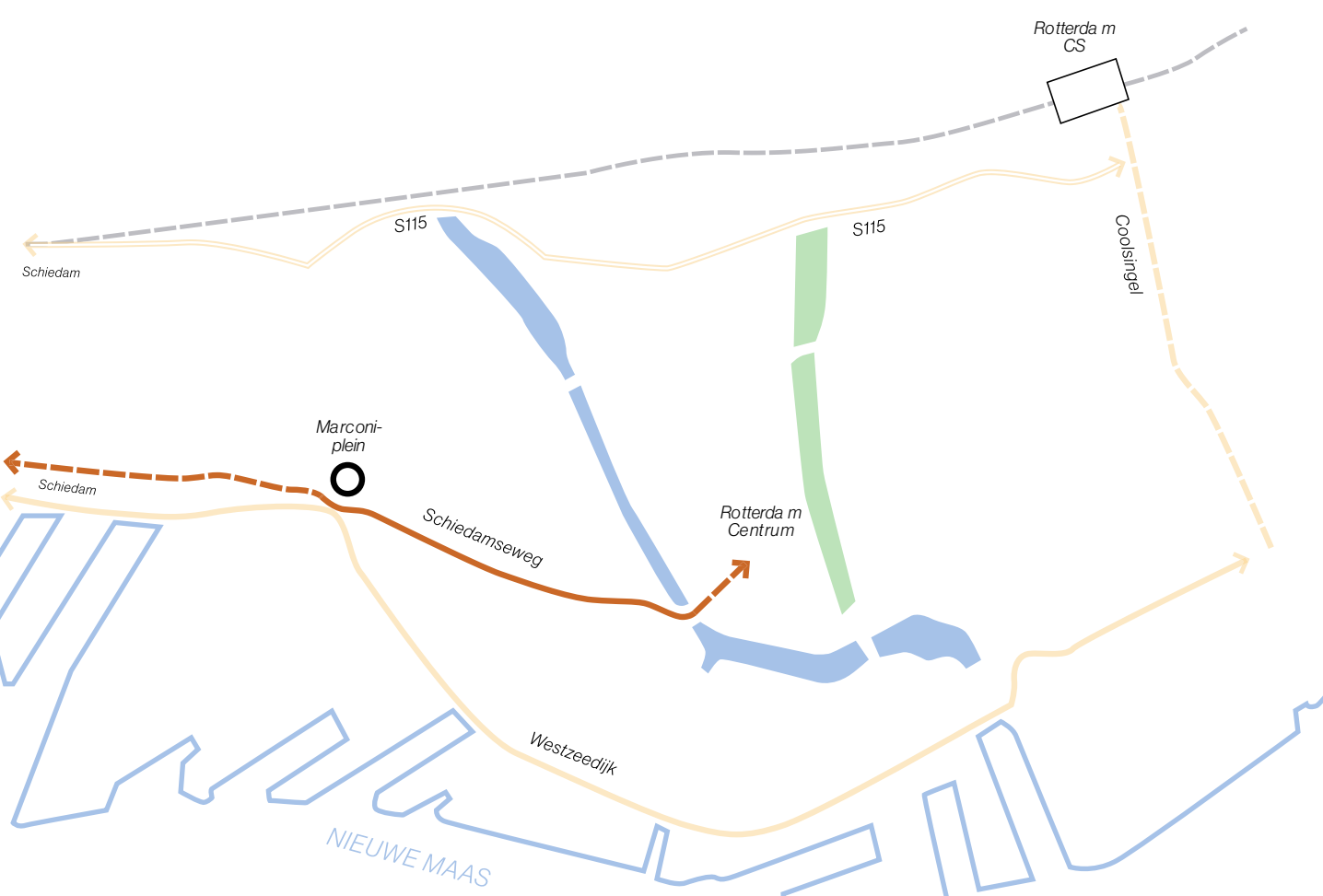

ZEBRA.

Analysis in different scales



City scale
The Schedamseweg is a short link connecting the City Center of Rotterdam with City and the surrounded neighbourhoods Bosplolder, Tussendijk and Delfshaven.

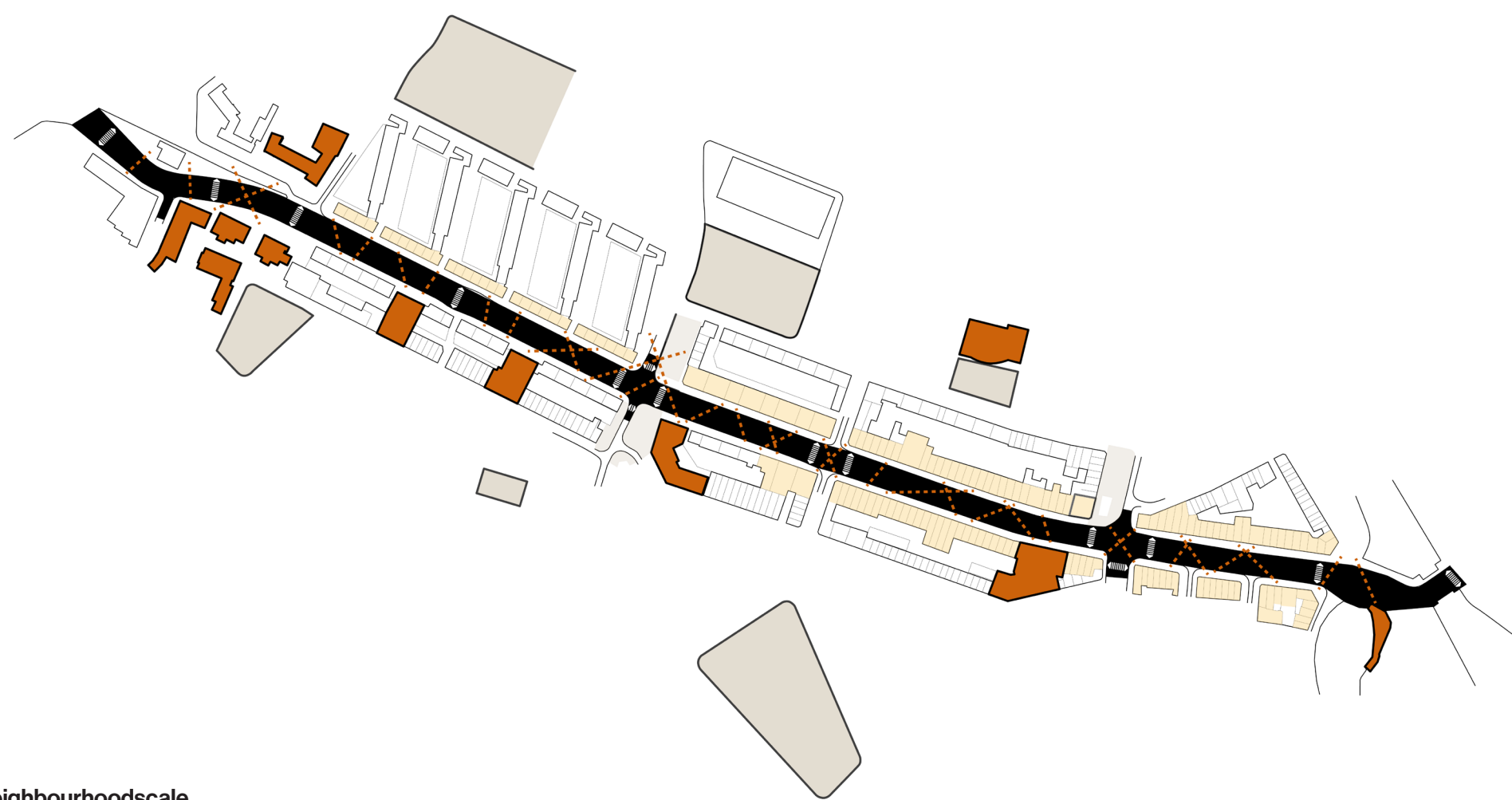

Neighbourhoodscale
The street as a barrier with of informal crossings connection important buildings within the neighbourhood.



Streetscale
The Schedamseweg is divided in different functions. Traffic and public transport, but also car parking take a dominant role within the street.

Problems and Fascinations

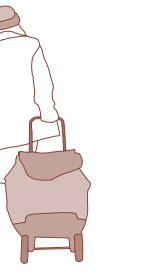
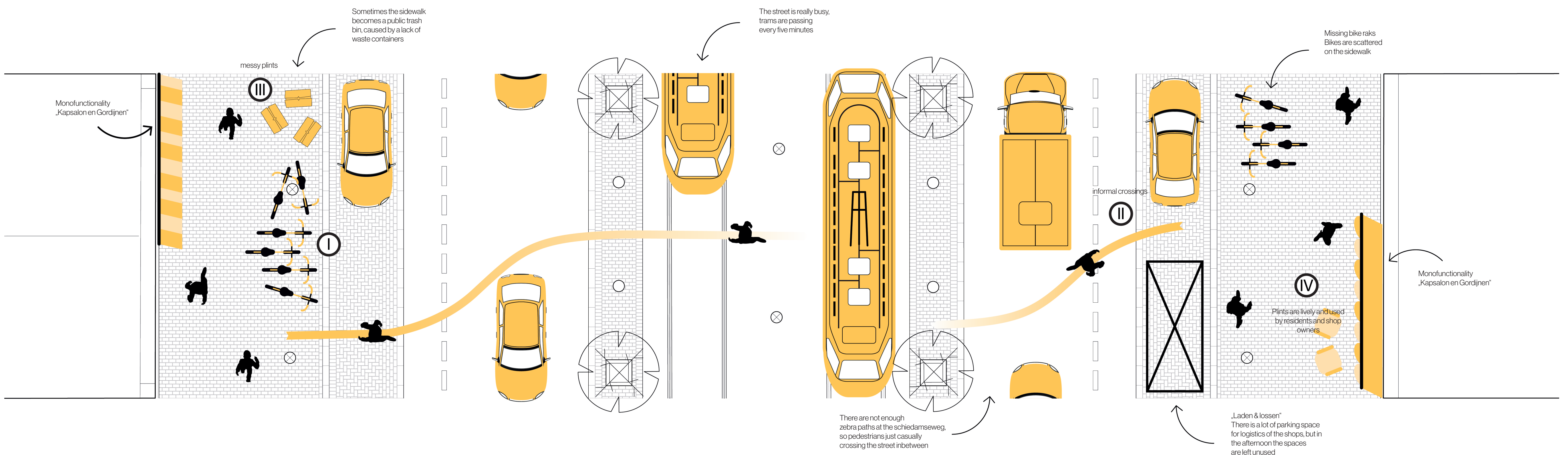

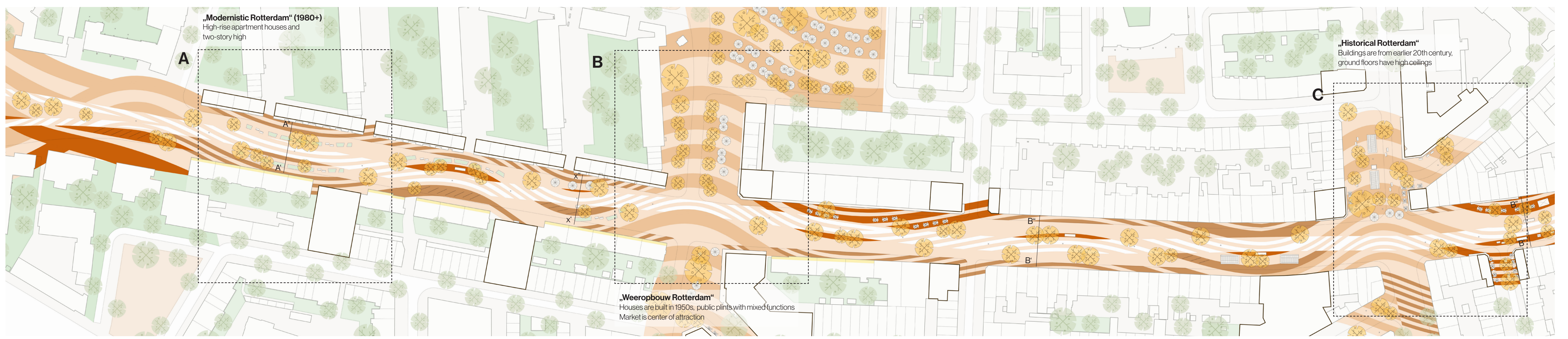

Masterplan
Scale to fit (ca. 1:1250)

Infographic
Pattern explained

The curved line is connecting all important places in the street and shaping the space to give it an unique pattern

The tram and bicycle axis is slightly changing it's direction in order to give the street an asymmetrical profile

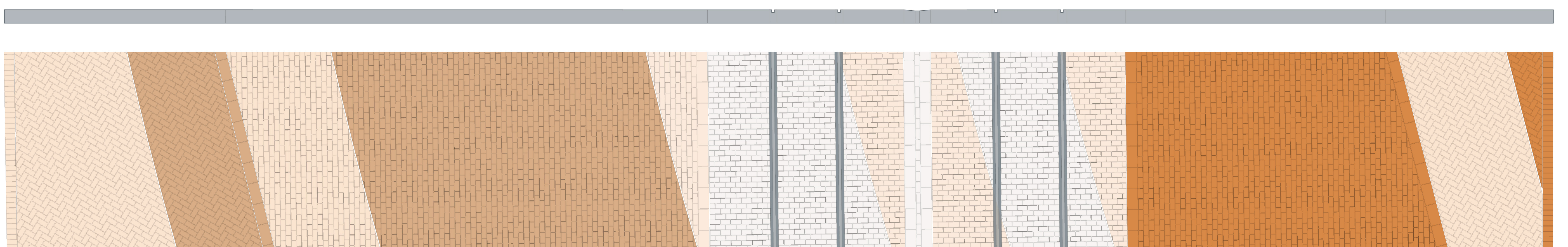
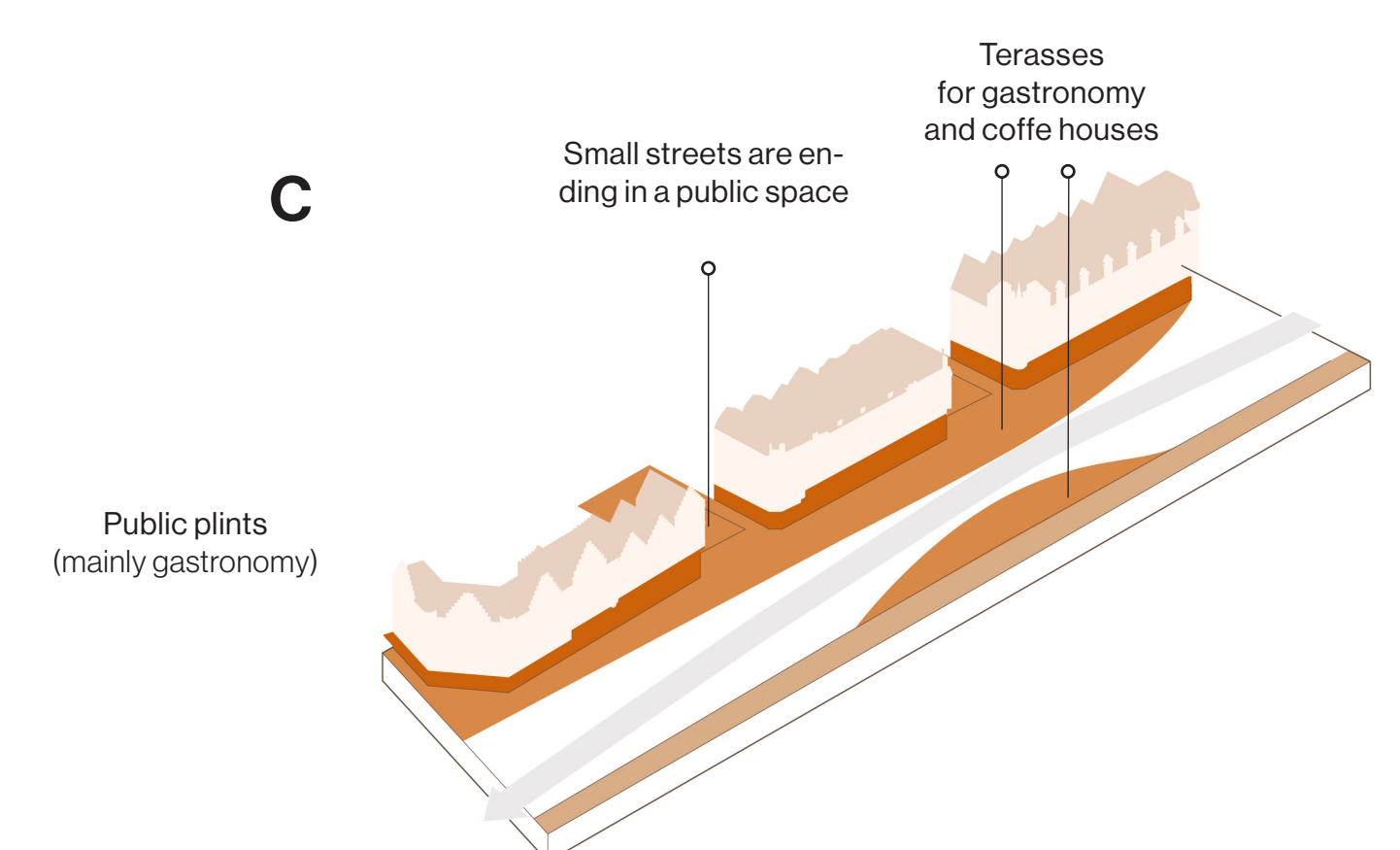
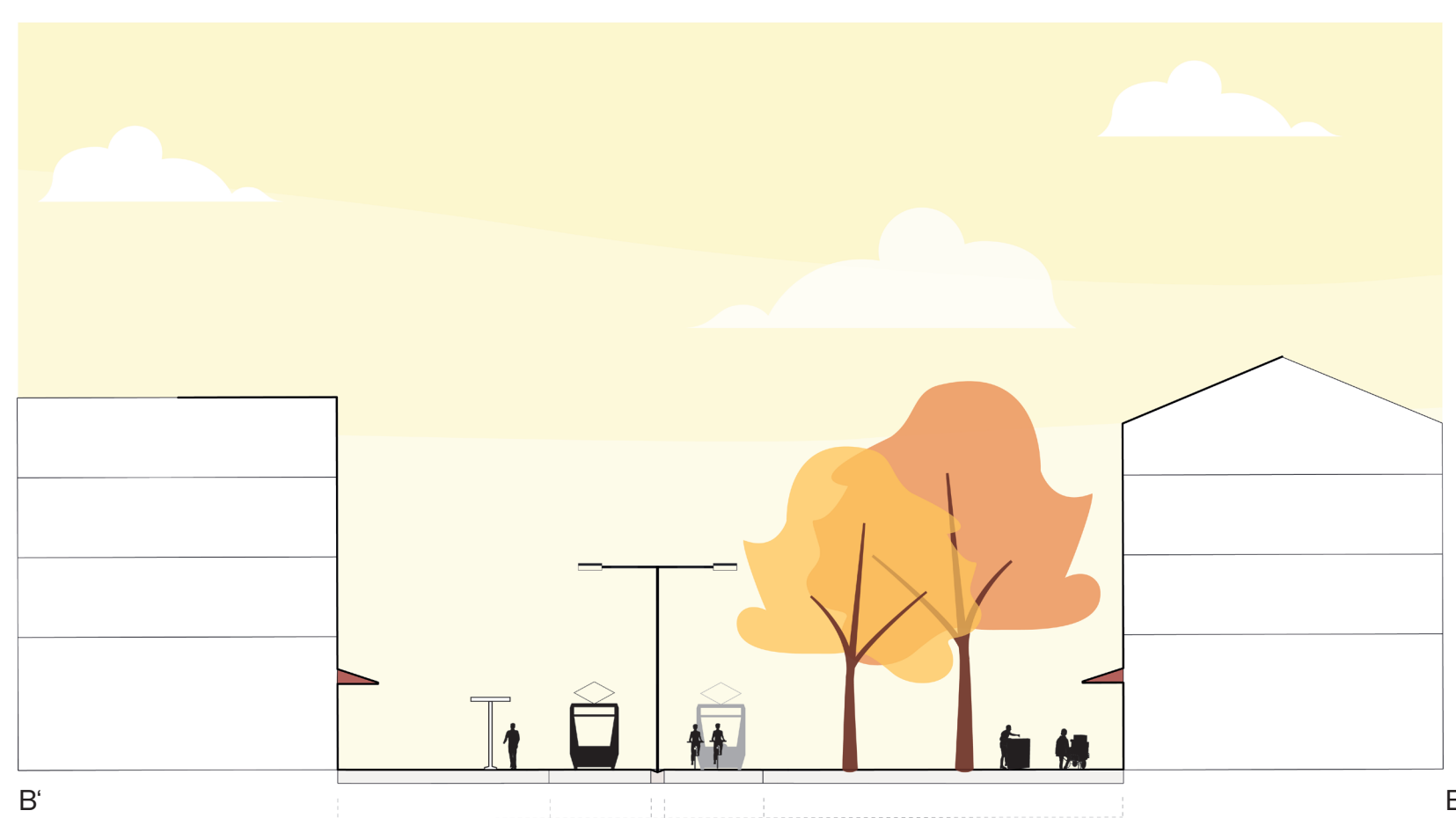
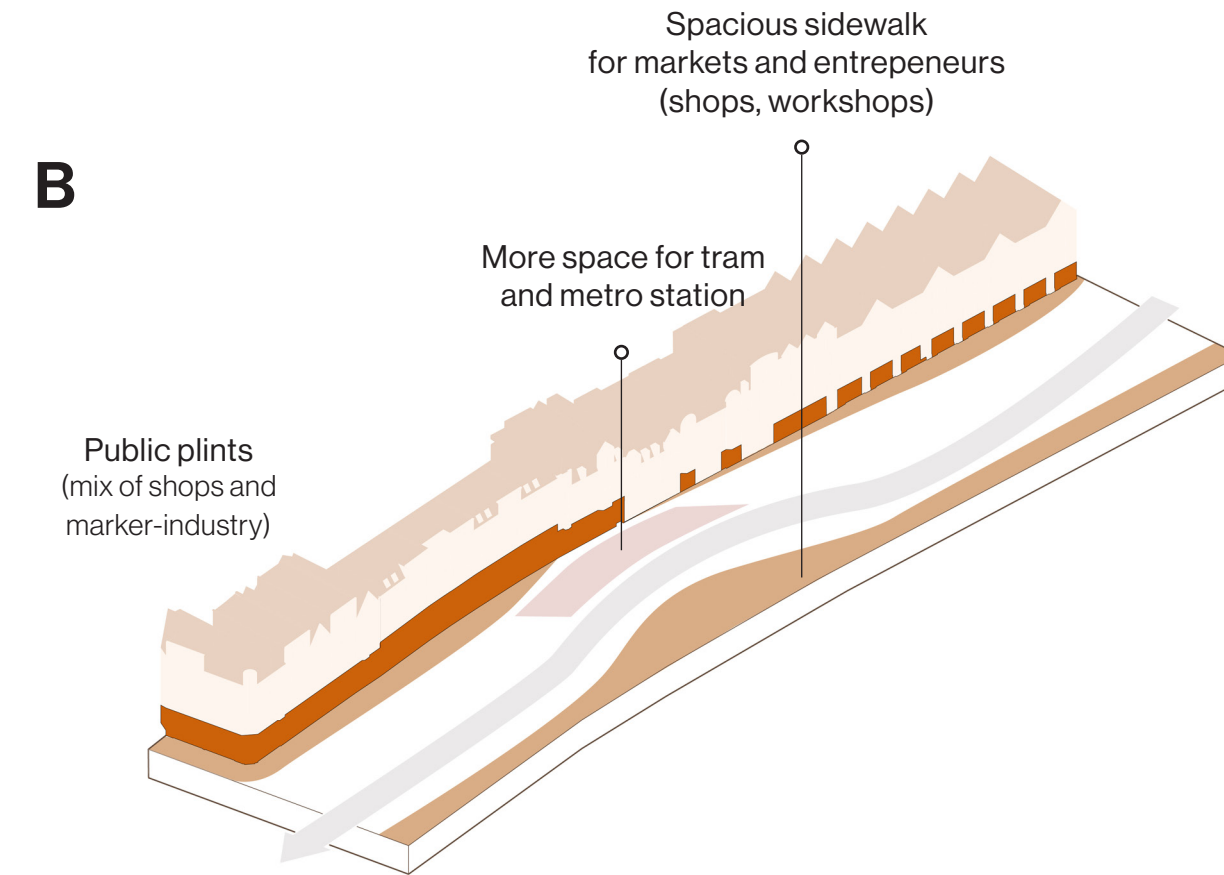
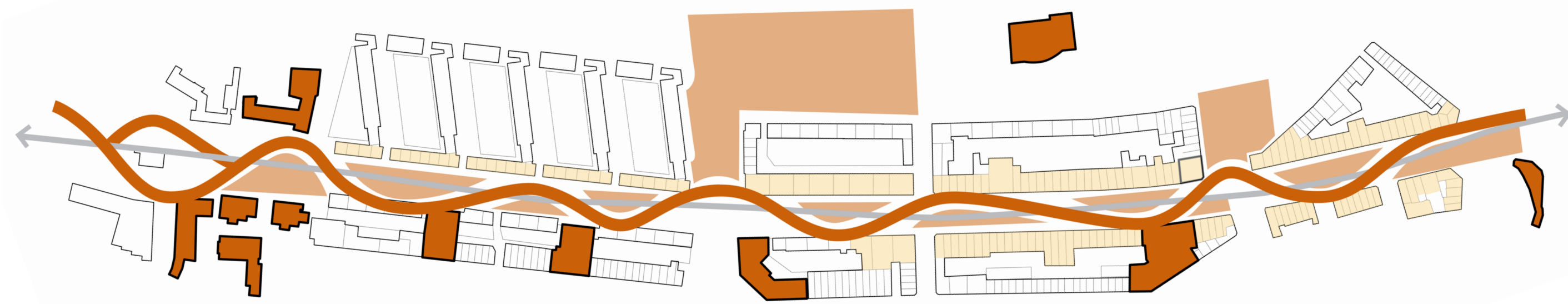

X1 Technical drawing - verharding
Scale to fit

X2

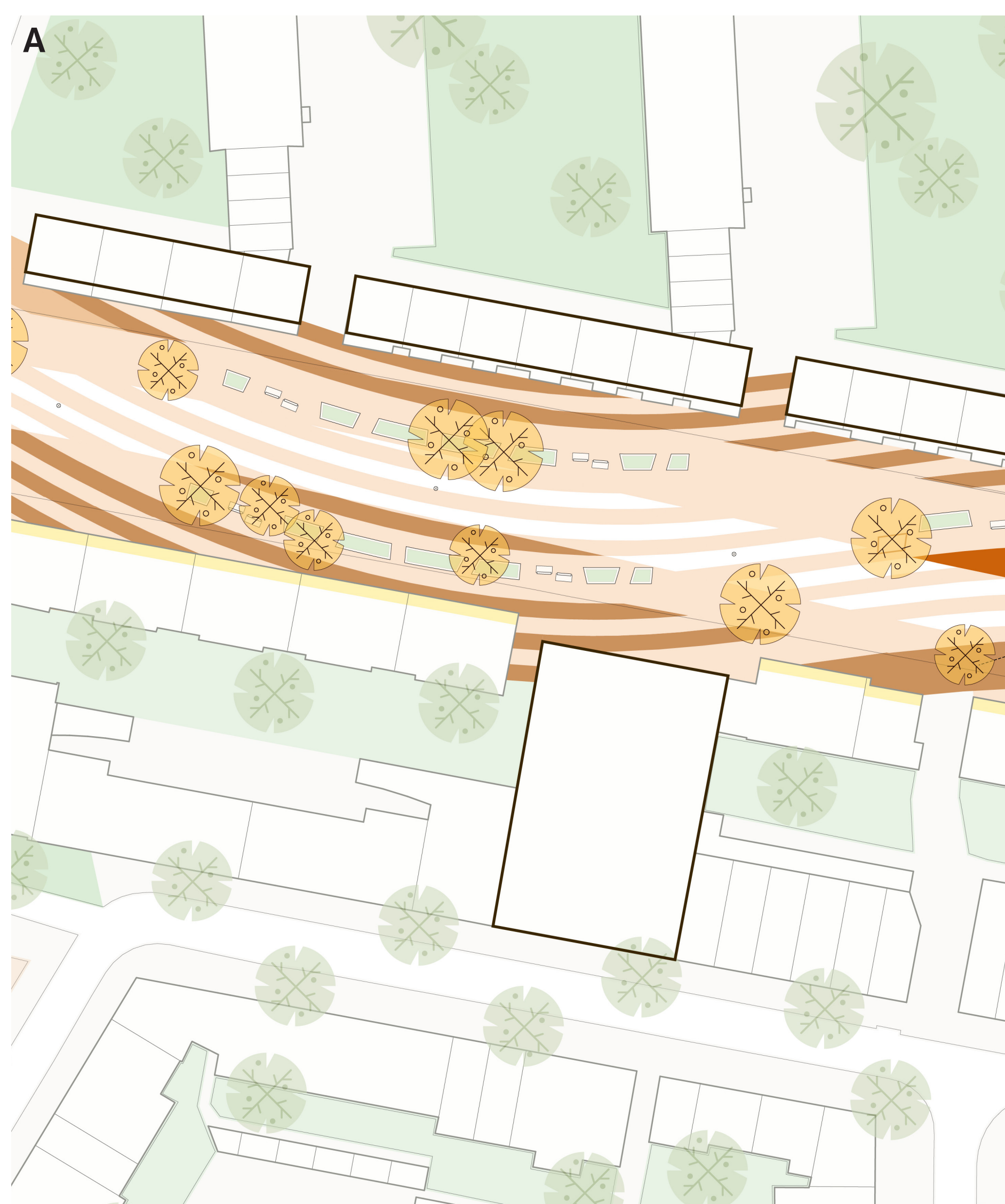

Detail 1500

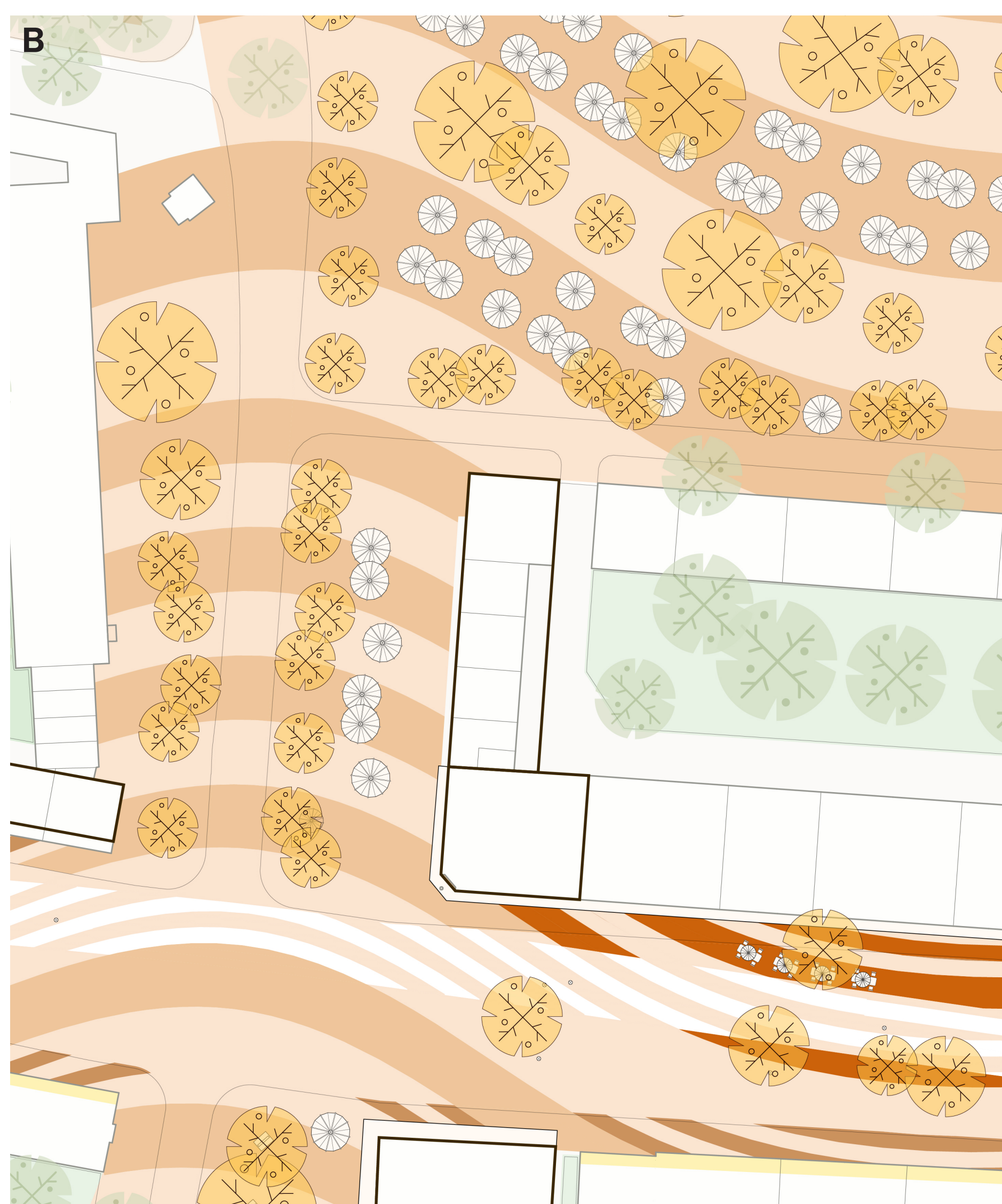

Detail 1500



Detail 1500